

Hybrid Pro Modular Closet 06

HPT-06
The Hybrid Pro™ Modular Closet 06 is versatile addition to any island booth. The locking door enables you to store and protect products and belongings while showcasing a brand at any event or tradeshow. Setup is simple with seamless SEG fabric graphics that push fit into long-lasting aluminum extrusion frames.



- features and benefits:**
- Closet provides locked and accessible storage and offers ample real estate for messaging and branding.
 - Kit includes silver extrusion frames, door and push-fit fabric graphics.
 - Locking doors keep contents within secure.
 - Ships freight

dimensions

Hardware	Graphic
Assembled unit: 118.11"W x 141.73"H x 43.74"D 3000mm(w) x 3600mm(h) x 1111mm(d) Approximate weight: 352 lbs / 160 kg	Refer to related graphic templates for more information Visit: www.exhibitors-handbook.com/graphic-templates Graphic material: Dye-sublimated fabric
Shipping	
Shipping dimensions - ships in OCF2 case: 51"L x 51"H x 23"D 1295mm(l) x 1295mm(h) x 584mm(d) Approximate shipping weight: 405 lbs / 184 kg	

additional information:

- Lifetime HW Warranty
- 1 Year Graphics Warranty
- Made in North America
- Recyclable

We are continually improving and modifying our product range and reserve the right to vary the specifications without prior notice. All dimensions and weights quoted are approximate and we accept no responsibility for variance. E&OE. See Graphic Templates for graphic bleed specifications.

HPT-06

ORBUS[®]
SETUP INSTRUCTIONS

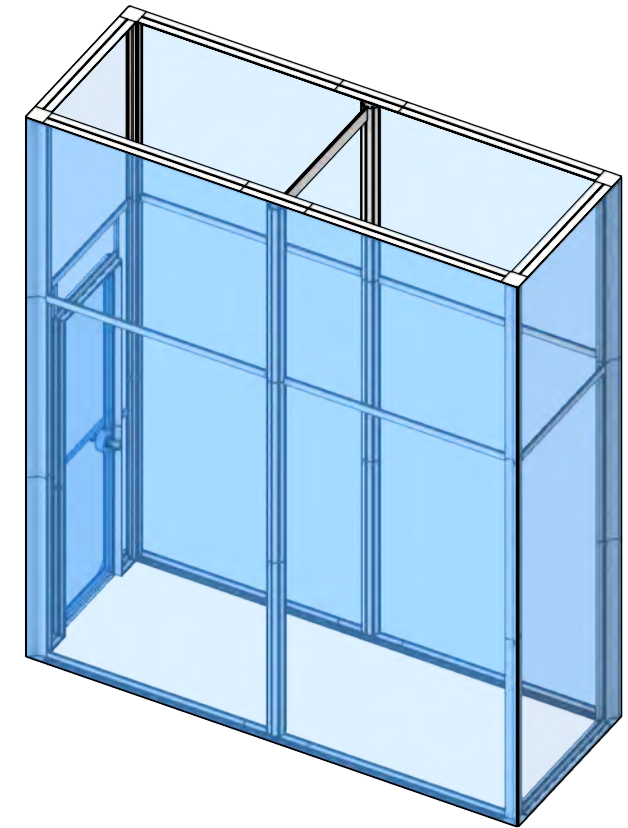
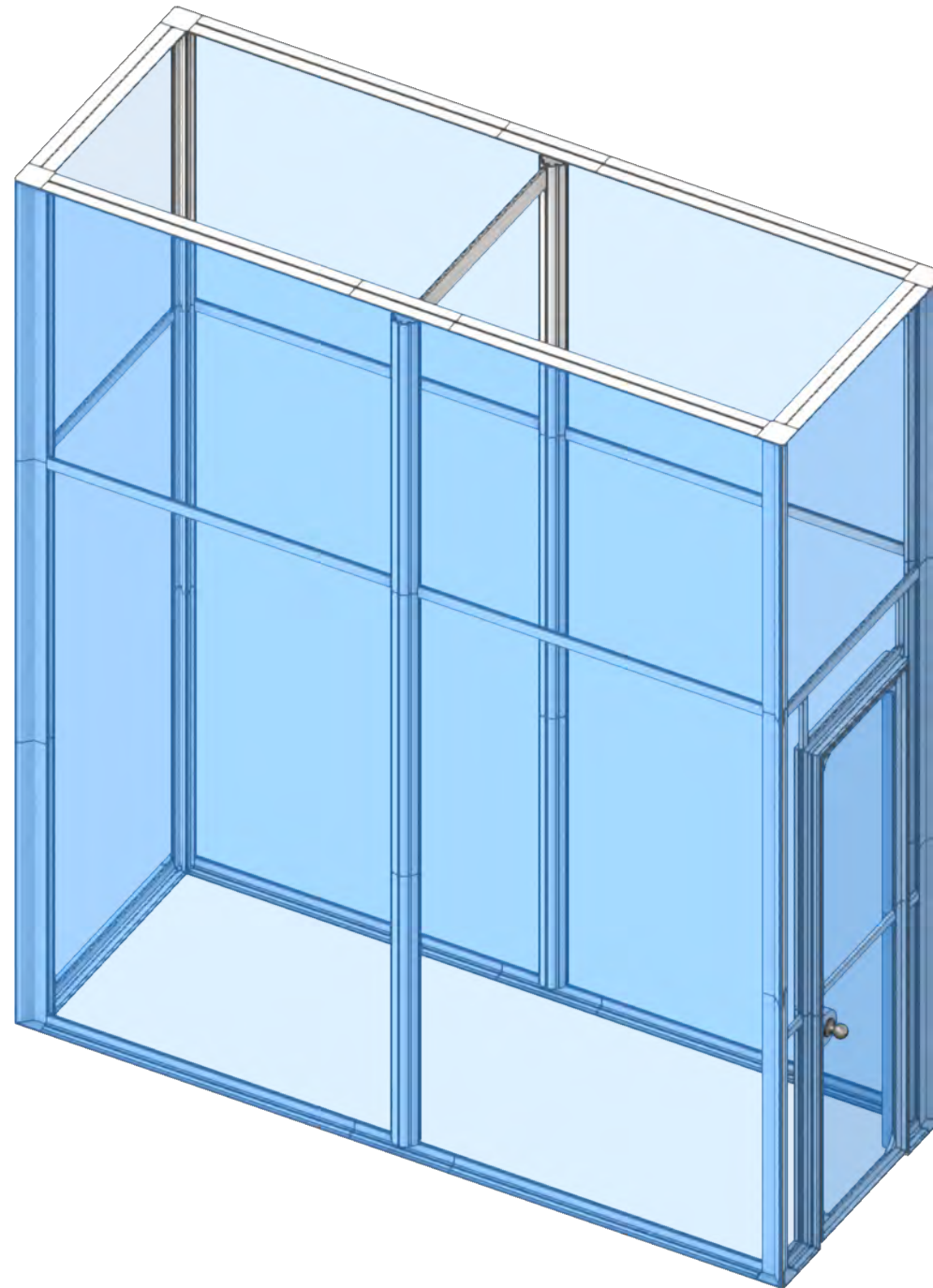

PROJECT BOM

SETUP#	HARDWARE	#	DESCRIPTION
A1	100-900-01-01	2	900MM LENGTH OF PH EXTRUSION-WITH CAM LOCKS BOTH ENDS
A2	100-1346-01-01	4	1346MM LENGTH OF PH EXTRUSION-WITH CAM LOCKS BOTH ENDS
A3	101-105-01-01	2	105MM LENGTH OF PH1 EXTRUSION-WITH CAM LOCKS BOTH ENDS
A4	101-210-01-01	2	210MM LENGTH OF PH1 EXTRUSION-WITH CAM LOCKS BOTH ENDS
A5	102-600-11	8	600MM LENGTH OF PH2 EXTRUSION WITH TENSION GLIDES
A6	102-900-01-01	1	900MM LENGTH OF PH2 EXTRUSION-WITH CAM LOCKS BOTH ENDS
A7	242-1155-01-09	4	1155MM LENGTH OF PM4R8-WITH STOPS AT 165MM ONE SIDE-WITH LOCKS 1 END
A8	242-1200-09-09	2	1200MM LENGTH OF PM4R8-WITH STOPS BOTH SIDES
A9	245-600-11	4	600MM 4-WAY INTERNAL CONNECTION EXTRUSION W/ 8 TENSION GLIDE
A10	340-388-02-02	4	388MM LENGTH OF PHFC4 EXTRUSION-WITH IB2 LOCK HOLES BOTH ENDS
A11	340-900-01-01	3	900MM LENGTH OF PHFC4 EXTRUSION-WITH CAM LOCKS BOTH ENDS
A12	340-1200-01-02	8	1200MM LENGTH OF PHFC4 EXTRUSION-WITH IB2 LOCK HOLES ONE END-CAM LOCK ONE END
A13	342-1193-10-10	8	1193MM OF PMFC4-90-B EXTRUSION -WITH STOPS AT 315MM
A14	342-1200-10-10	4	1200MM OF PMFC4-90-B EXTRUSION -WITH STOPS AT 315MM
IB2-O	IB2-O	8	JOINER BAR (OLD STYLE)
CAP	PMFC4-90-B-CAP	8	PLASTIC MOLDED END CAP FOR THE PMFC4-90-B EXTRUSION
DOOR	VF-FCD-900-LS	1	VECTOR FRAME FABRIC CHANNEL DOOR 900MM X 2400MM X 100MM FRAME LEFT SPLIT DOOR
SETUP#	GRAPHICS	#	DESCRIPTION
GR-A	HPT-06-A-G	1	GRAPHIC (A) (121.68 w X 145.61 h total size) 117.68 w X 141.61 h finish size, Dye-sub print on Eclipse Blockout Stretch, single sided, sewn with FCE-2 silicone beading around perimeter & pull tab in bottom right corner
GR-B	HPT-06-B-G	1	GRAPHIC (B) (47.35 w X 145.61 h total size) 43.35 w X 141.61 h finish size, Dye-sub print on Eclipse Blockout Stretch, single sided, sewn with FCE-2 silicone beading around perimeter & pull tab in bottom right corner
GR-C	HPT-06-C-G	1	GRAPHIC (C) (26.95 w X 85.38 h total size) 22.95 w X 81.38 h finish size, Dye-sub print on Eclipse Blockout Stretch, single sided, sewn with FCE-2 silicone beading around perimeter & pull tab in bottom right corner
LN-C	HPT-06-C-OP-LN	1	LINER (C) (26.95 w X 85.38 h total size) 22.95 w X 81.38 h finish size, Opaque Liner, sewn with FCE-2 silicone beading around perimeter & pull tab in bottom right corner
GR-D	HPT-06-D-G	1	GRAPHIC (D) (121.68 w X 145.61 h total size) 117.68 w X 141.61 h finish size, Dye-sub print on Eclipse Blockout Stretch, single sided, sewn with FCE-2 silicone beading around perimeter & pull tab in bottom right corner
GR-E	HPT-06-E-G	1	GRAPHIC (E) (47.35 w X 145.61 h total size) 43.35 w X 141.61 h finish size, Dye-sub print on Eclipse Blockout Stretch, single sided, sewn with FCE-2 silicone beading around perimeter & pull tab in bottom right corner

FABRIC, VINYL & UV GRAPHIC CARE GUIDELINES

GENERAL HANDLING FABRIC GRAPHICS

- Your fabric graphics should always be handled in a clean and dry area with clean hands. When possible, use white fabric gloves.
- Be sure fabric is clean and dry before packing.
- Machine washing and/or drying is not recommended for all fabrics. Refer to the chart below for which fabrics are washable.

EMERGENCY STAIN TREATMENT (FABRIC)

1. For dry stains, like loose dirt or pencil marks, try inititally using masking tape or Magic Eraser (dry-not moistened).
2. Introduce water or liquids to treat stains, if at all possible, treat the stain with fabric off of the frame.

- Place a clean dry cloth behind stain (to absorb stains while being treated). Mositen another cloth initially with just water (distilled water is optimal, if available).

- Gently blot stain with moistened cloth (or small area of moistened Magic Eraser), while trying to push stain through to the back, using the dry cloth to absorb.

- Repeat using care to keep the wet area as small as possible.

- Grandma's Secret Spot remover can be an effective stain remover. Mix severall drops in a small cup with clean water. Repeat above and using dry cloth on back of stain to absorb.

MACHINE WASHING FABRIC GRAPHICS

- Cold water/delicate cycle/tumble dry low or air dry. For stretch fabrics do not use dryer, let hang dry.
- Use caution on dryer time with graphics containing liners. It's best to put tension fabric on frame when fabric is still damp and let it air dry. Always be sure that the aluminum frame is clean when mounting the damp graphic.
- Fabric stretch graphics that are washed and mahcine dried may shink up to 3/4" per every 50" of fabric in the direction of the stretch and shink up to 1/4" in non stretch direction.

STORING & PACKING BACKLIT GRAPHICS

- To avoid cracks in the ink or having to steam graphics, Backlit fabrics should be loosely folded with bubble wrap or stored around a tube.
- Avoid folding the graphic tightly to store in a small bag or box.

GENERAL HANDLING VINYL & UV GRAPHICS

- Vinyl banners and rigid graphics should always be handled in a clean and dry area with clean hands. When possible, use white fabric groves.
- Be sure vinyl/ UV is clean and dry before packing. Always follow material handing and packing instrcutions included.
- All vinyl material should be rolled with graphic facing in to protect the graphic printed side. Roll on a tube in available.
- Avoid folding material to reduce the risk of crease lines and chipped inks. If a graphic must be folded, try and fold loosely and as few times as possible.

EMERGENCY STAIN TREATMENT (UV)

- For dry stains, like loose dirt, pencil marks or adhesive, try initially using masking tape, Masking tape can be quite effective at lifting dry surface dirt. Try 'pulling' as much of stain away as you can and avoid rubing the stain into the material.
- While using Windex® avoid scrubbing harshly. Too much pressure can fade the graphic print.

GENERAL HANDING OF ROLLABLE PVC PANELS

All mural panels, truss panels and detachables should be rolled with the graphic facing out to protect the graphic printed side. Mural panels should be stored in the original plastic sleeves that are provided with the panels.

STEAMING FABRIC GRAPHICS

- For optimal results, steam wrinkles when fabric is tensioned and installed securely on the frame.
- Fill steamer with clean drinking water or distilled water. Avoid using water containing hard minerals.
- Hold steamer upright and hold close to fabric. Avoid touching fabric with steamer.
- Do not tap steamer as water drips may cause water marks to from on graphic

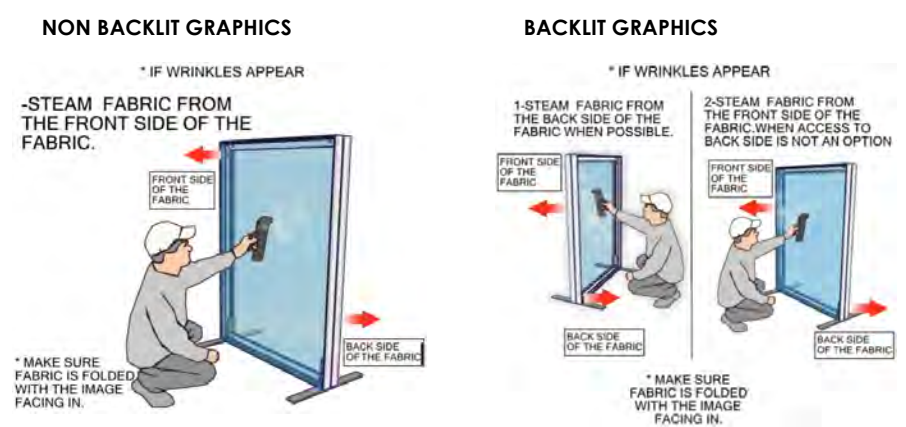

FABRIC					
	WASHING MACHINE	DRY CLEAN	SPOT CLEAN	STEAMING / IRON	MAGIC ERASER
RESILIENCE	NO	NO	NO	NO	YES (ONLY ON WHITE)
OXFORD	YES	YES	YES	YES	YES
POWER STRETCH	YES	YES	YES	YES	YES
DISPLAY POLYESTER	YES	YES	YES	YES	YES
DISPLY POLY TABLE THROWS	YES	YES	YES	YES	YES
OUTDOOR FLAG	YES (MUST VELCRO THE TABS)	N/A (MUST VELCRO THE TABS)	YES	YES	YES
CANVAS OUTDOOR	NO	NO	YES	STEAM ONLY	YES
CANVAS LIGHTBOX	NO	NO	NO	STEAM ONLY	YES
AGILITY	YES	YES	YES	(ONLY W/ 100% TENSION)	YES
SUPER STRETCH	YES	YES	YES	(ONLY W/ 100% TENSION)	YES
TRIPLE WHITE	YES	YES	NO	YES	NO
ECLIPSE	NO	NO	YES	STEAM ONLY	YES
SOFT KNIT	YES	YES	YES	YES	YES
SHEER	YES	YES	YES	YES	YES
VINYL & ROLLABLE					
	SOLVENT	SOAPY WATER (Dawn)	WINDEX		
FLATMAXX	ONLY ON WHITE	YES	NO		
SCRIM 13OZ/ 18OZ	ONLY ON WHITE	YES	NO		
VINLY 20OZ	ONLY ON WHITE	YES	NO		
MELINEX	NO	YES	NO		
MURAL PANELS	NO	YES	YES		
UV RIDGED	NO	YES	YES		

SETUP NOTES

Redesign of this exhibit without approval by Orbus may result in dangerous and unsafe structures. Nimlok disclaims any responsibility for redesigned exhibits it does not approve in writing.

Parts and components such as panels and extrusions are manufactured to metric sizing. Where ever possible sizes have been noted in feet and inches as well as in metric. Below is the imperial to metric sizing table for reference. "Nominal" refers to approximate size.

NOTE: PARTS MAY COME PRE-ASSEMBLED FOR PACKING PURPOSES.

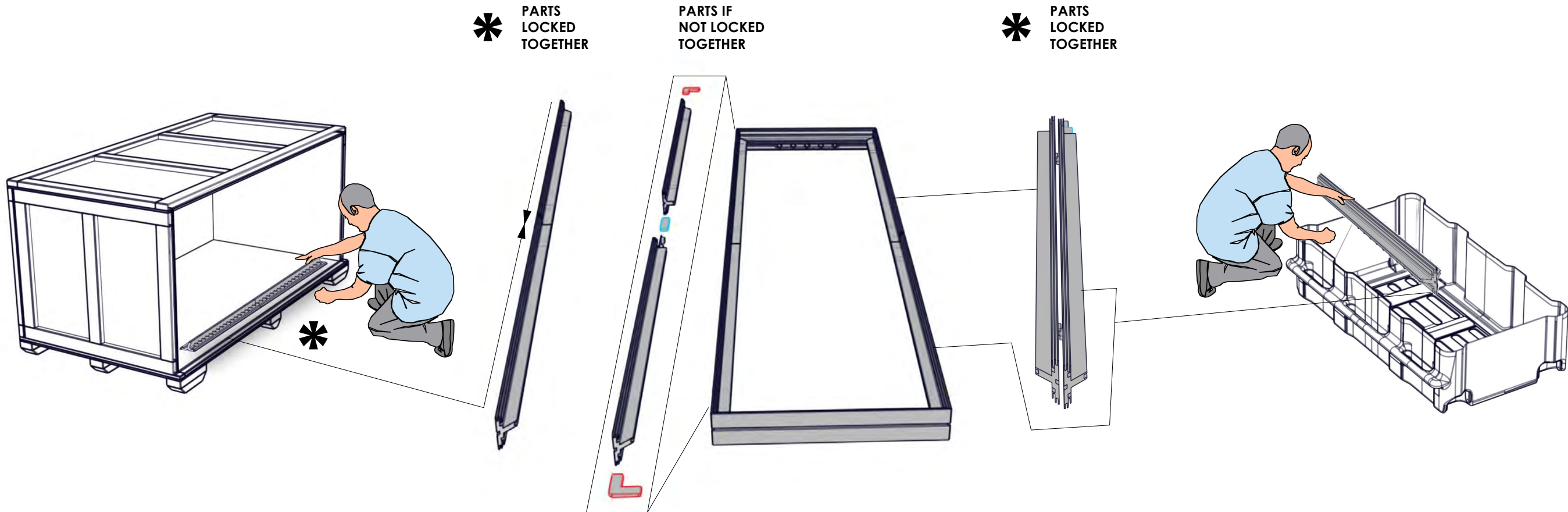

METRIC TO IMPERIAL DIMENSION

2400mm = (94.50")	1200mm = (47.25")
2100mm = (82.67")	900mm = (35.43")
1800mm = (70.87")	600mm = (23.62")
1500mm = (59.05")	300mm = (11.81")



Internet Connection



Phone Line



Main Electric Drop (Point Of Distribution)



Electrical Outlet



Sharp Edges

----- Cables Under Carpet -----

HELPFUL SETUP QR CODES



**SCAN QR CODES
WITH YOUR PHONE
CAMERA**

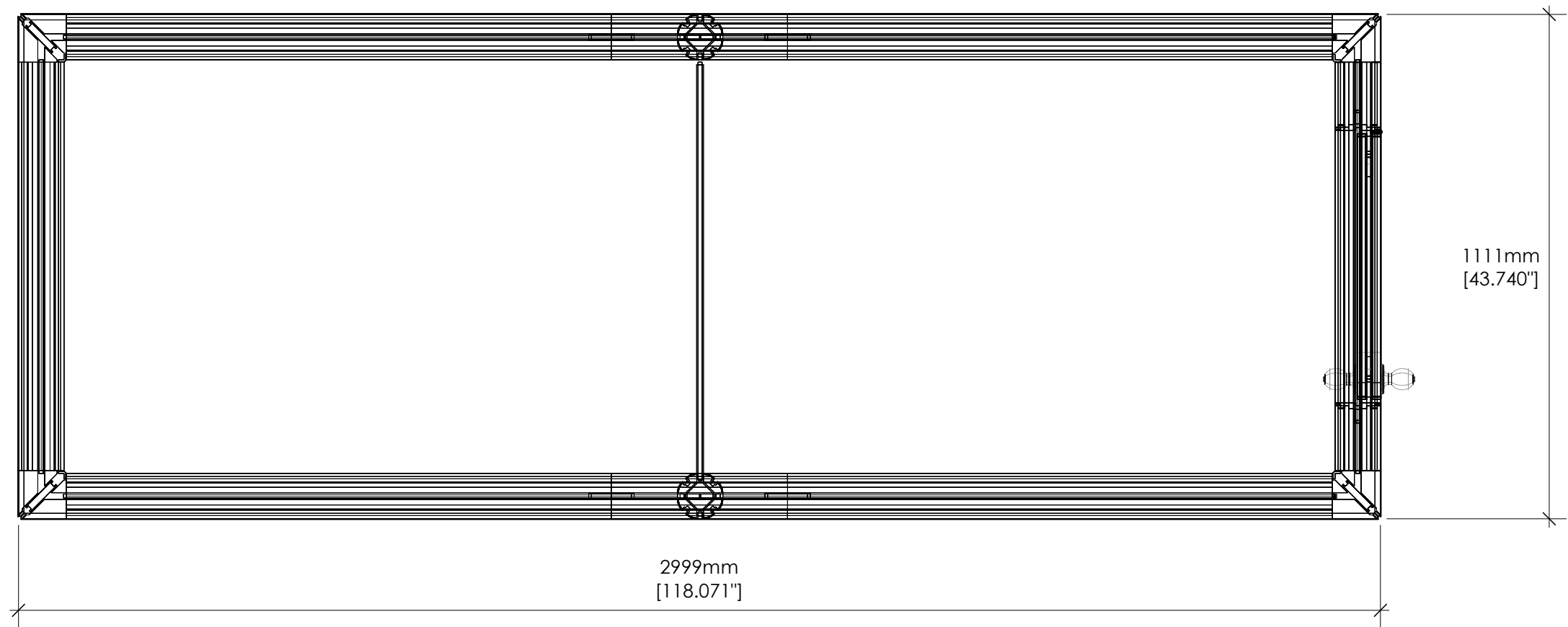

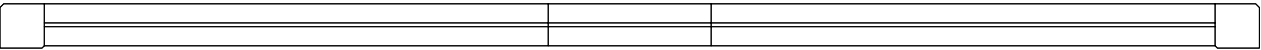
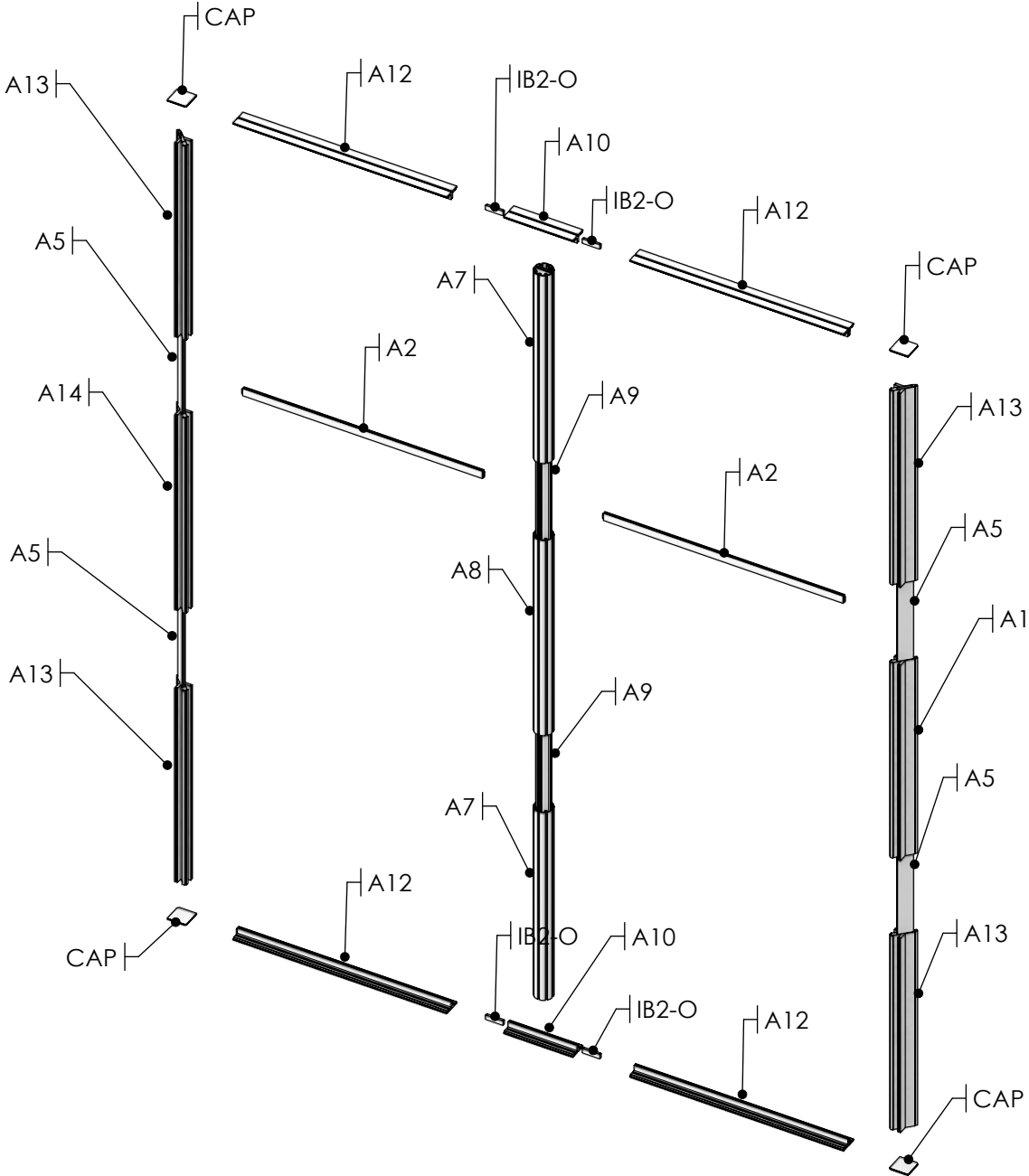

SETUP#	#	DESCRIPTION
CAP	4	PLASTIC MOLDED END CAP FOR THE PMFC4-90-B EXTRUSION
A13	4	1193MM OF PMFC4-90-B EXTRUSION -WITH STOPS AT 315MM
A5	4	600MM LENGTH OF PH2 EXTRUSION WITH TENSION GLIDES
A14	2	1200MM OF PMFC4-90-B EXTRUSION -WITH STOPS AT 315MM
A12	4	1200MM LENGTH OF PHFC4 EXTRUSION-WITH IB2 LOCK HOLES ONE END-CAM LOCK ONE END
IB2-O	4	JOINER BAR (OLD STYLE)
A10	2	388MM LENGTH OF PHFC4 EXTRUSION-WITH IB2 LOCK HOLES BOTH ENDS
A7	2	1155MM LENGTH OF PM4R8-WITH STOPS AT 165MM ONE SIDE-WITH LOCKS 1 END
A8	1	1200MM LENGTH OF PM4R8-WITH STOPS BOTH SIDES
A9	2	600MM 4-WAY INTERNAL CONNECTION EXTRUSION W/ 8 TENSION GLIDE
A2	2	1346MM LENGTH OF PH EXTRUSION-WITH CAM LOCKS BOTH ENDS

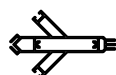

COMPONENTS
IN THIS STEP:
(Not to scale)

342 (90B)



102 (PH2)

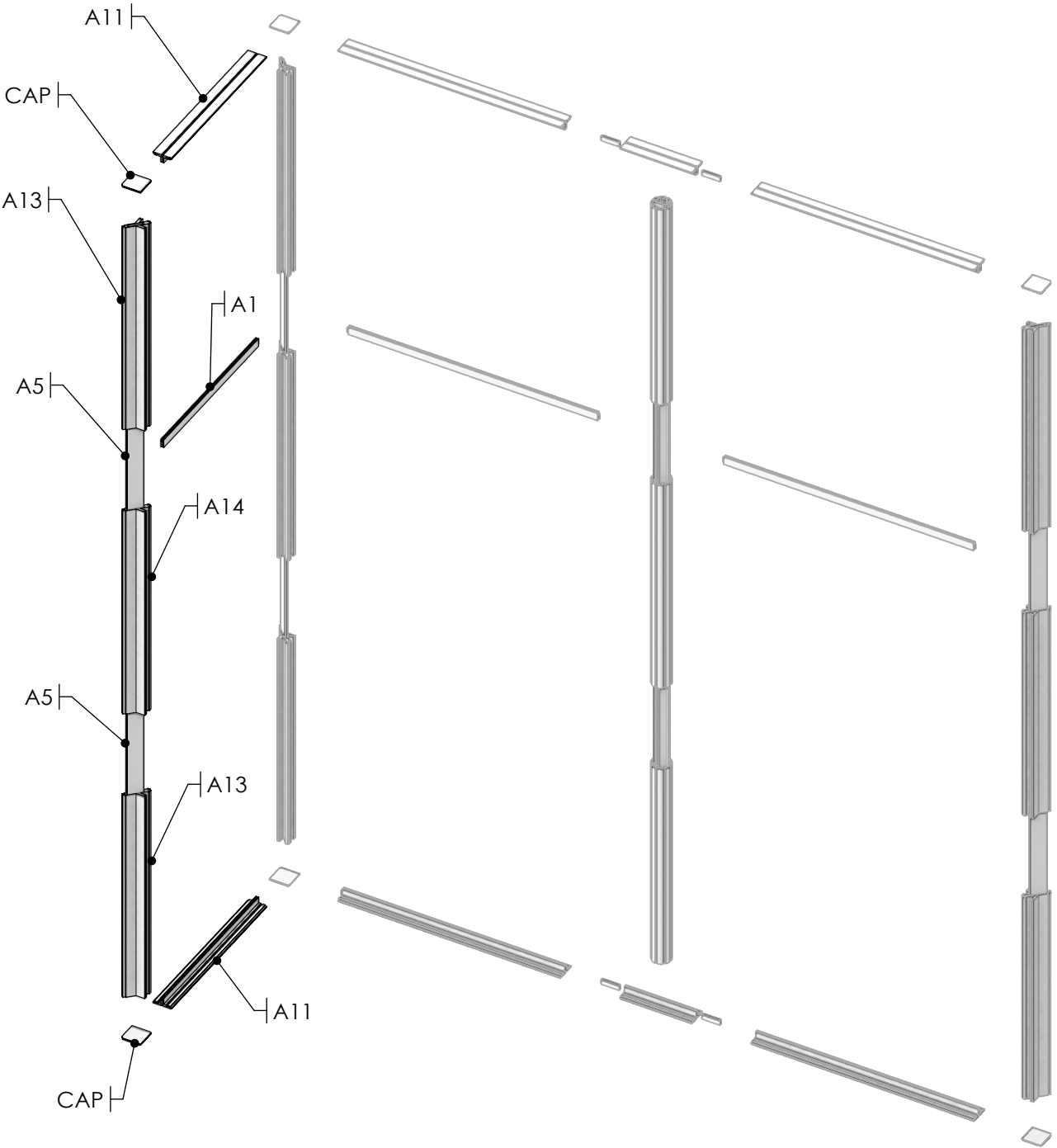

340 (PHFC4)

SETUP#	#	DESCRIPTION
CAP	2	PLASTIC MOLDED END CAP FOR THE PMFC4-90-B EXTRUSION
A13	2	1193MM OF PMFC4-90-B EXTRUSION -WITH STOPS AT 315MM
A5	2	600MM LENGTH OF PH2 EXTRUSION WITH TENSION GLIDES
A14	1	1200MM OF PMFC4-90-B EXTRUSION -WITH STOPS AT 315MM
A11	2	900MM LENGTH OF PHFC4 EXTRUSION-WITH CAM LOCKS BOTH ENDS
A1	1	900MM LENGTH OF PH EXTRUSION-WITH CAM LOCKS BOTH ENDS

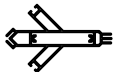

COMPONENTS
IN THIS STEP:
(Not to scale)

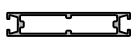
342 (90B)



102 (PH2)

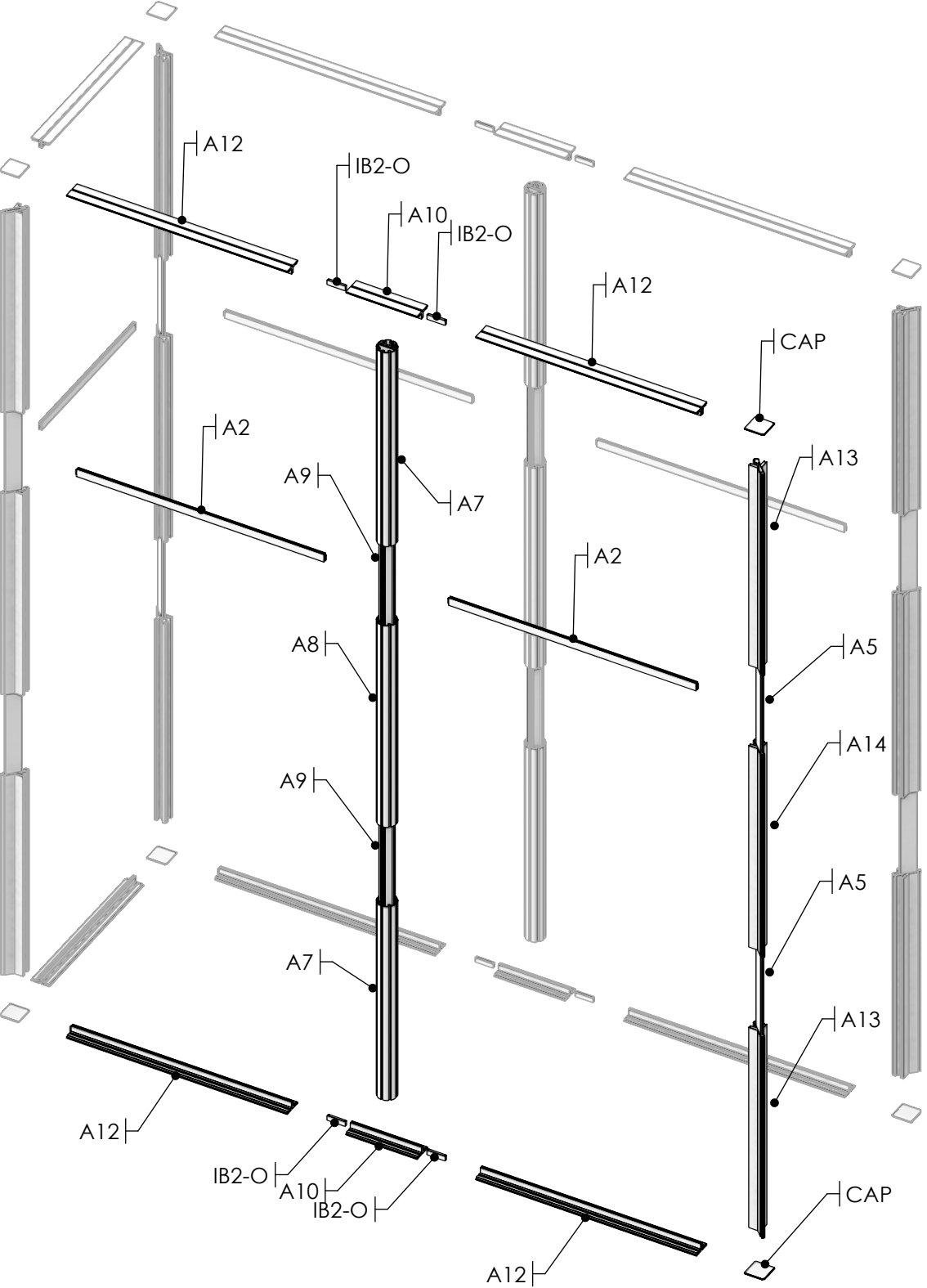

340 (PHFC4)

SETUP#	#	DESCRIPTION
CAP	2	PLASTIC MOLDED END CAP FOR THE PMFC4-90-B EXTRUSION
A13	2	1193MM OF PMFC4-90-B EXTRUSION -WITH STOPS AT 315MM
A5	2	600MM LENGTH OF PH2 EXTRUSION WITH TENSION GLIDES
A14	1	1200MM OF PMFC4-90-B EXTRUSION -WITH STOPS AT 315MM
A12	4	1200MM LENGTH OF PHFC4 EXTRUSION-WITH IB2 LOCK HOLES ONE END-CAM LOCK ONE END
IB2-O	4	JOINER BAR (OLD STYLE)
A10	2	388MM LENGTH OF PHFC4 EXTRUSION-WITH IB2 LOCK HOLES BOTH ENDS
A7	2	1155MM LENGTH OF PM4R8-WITH STOPS AT 165MM ONE SIDE-WITH LOCKS 1 END
A8	1	1200MM LENGTH OF PM4R8-WITH STOPS BOTH SIDES
A9	2	600MM 4-WAY INTERNAL CONNECTION EXTRUSION W/ 8 TENSION GLIDE
A2	2	1346MM LENGTH OF PH EXTRUSION-WITH CAM LOCKS BOTH ENDS

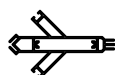

COMPONENTS
IN THIS STEP:
(Not to scale)

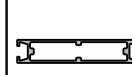



342 (90B)

102 (PH2)

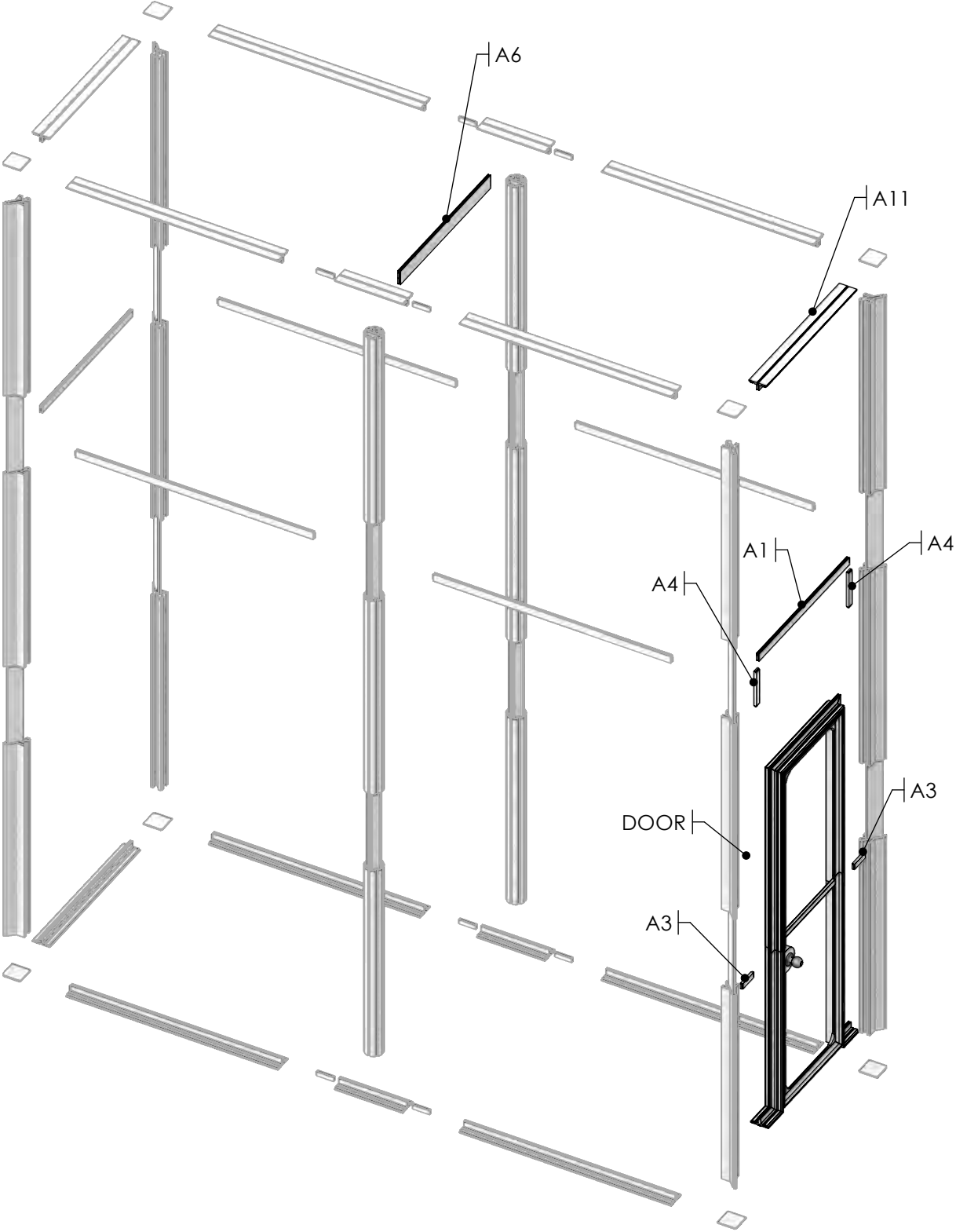
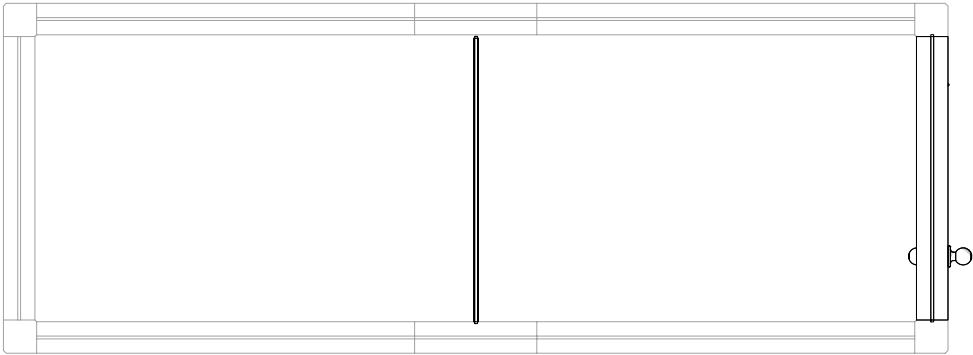

340 (PHFC4)

SETUP#	#	DESCRIPTION
A11	1	900MM LENGTH OF PHFC4 EXTRUSION-WITH CAM LOCKS BOTH ENDS
A4	2	210MM LENGTH OF PH1 EXTRUSION-WITH CAM LOCKS BOTH ENDS
A3	2	105MM LENGTH OF PH1 EXTRUSION-WITH CAM LOCKS BOTH ENDS
DOOR	1	VECTOR FRAME FABRIC CHANNEL DOOR 900MM X 2400MM X 100MM FRAME LEFT SPLIT DOOR
A1	1	900MM LENGTH OF PH EXTRUSION-WITH CAM LOCKS BOTH ENDS
A6	1	900MM LENGTH OF PH2 EXTRUSION-WITH CAM LOCKS BOTH ENDS

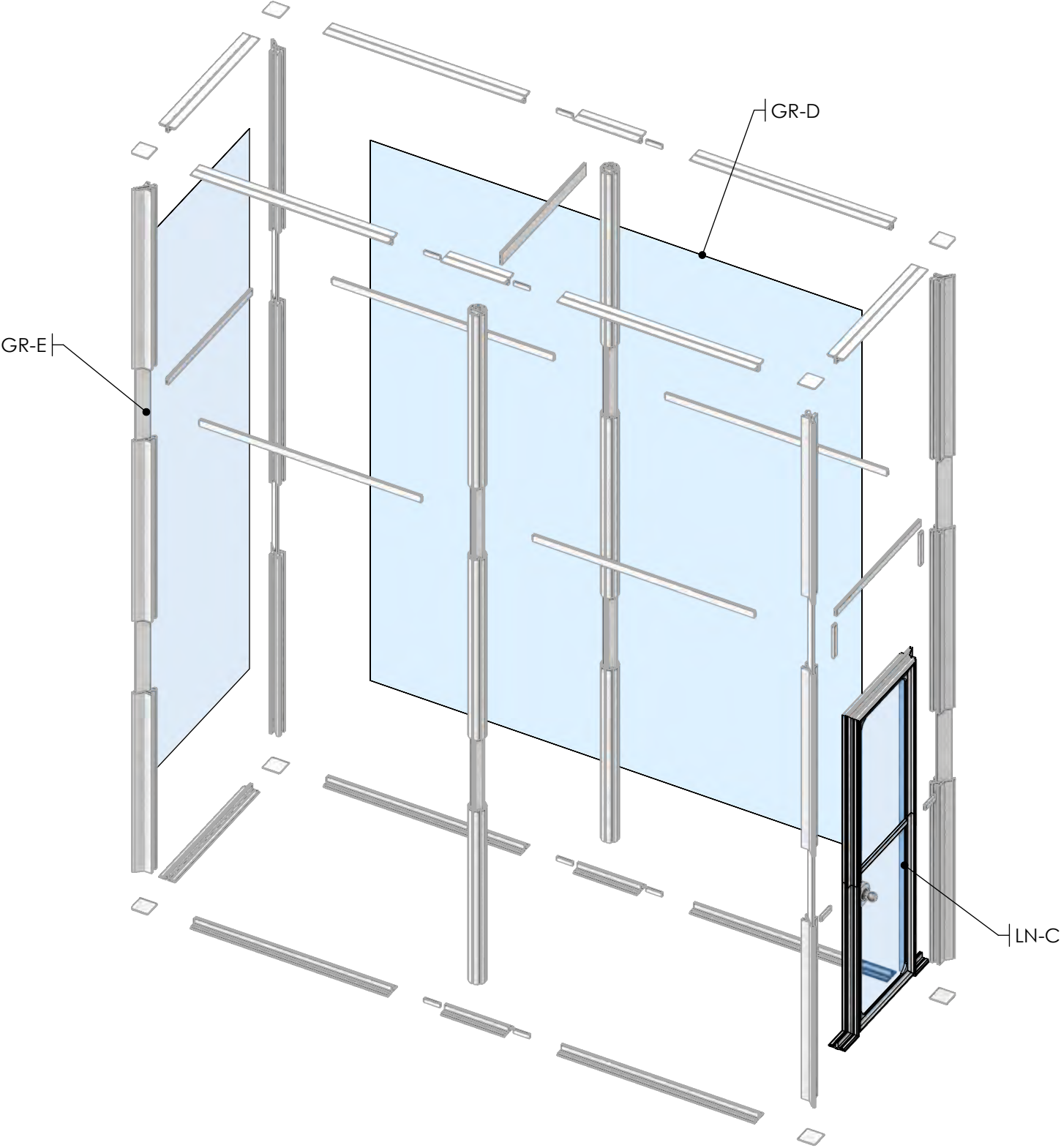
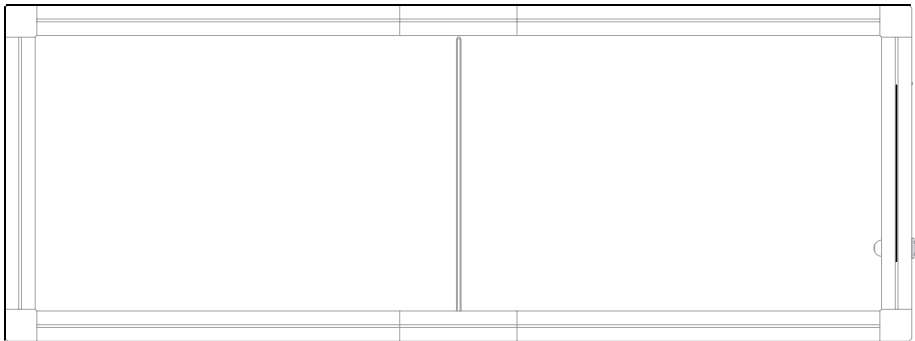

COMPONENTS IN THIS STEP: (Not to scale)	 101 (PH1)	 340 (PHFC4)	 102 (PH2)
---	---	---	---

SETUP#	#	DESCRIPTION
GR-E	1	GRAPHIC (E) (47.35 w X 145.61 h total size) 43.35 w X 141.61 h finish size, Dye-sub print on Eclipse Blockout Stretch, single sided, sewn with FCE-2 silicone beading around perimeter & pull tab in bottom right corner
GR-D	1	GRAPHIC (D) (121.68 w X 145.61 h total size) 117.68 w X 141.61 h finish size, Dye-sub print on Eclipse Blockout Stretch, single sided, sewn with FCE-2 silicone beading around perimeter & pull tab in bottom right corner
LN-C	1	LINER (C) (26.95 w X 85.38 h total size) 22.95 w X 81.38 h finish size, Opaque Liner, sewn with FCE-2 silicone beading around perimeter & pull tab in bottom right corner



SETUP#	#	DESCRIPTION
GR-A	1	GRAPHIC (A) (121.68 w X 145.61 h total size) 117.68 w X 141.61 h finish size, Dye-sub print on Eclipse Blockout Stretch, single sided, sewn with FCE-2 silicone beading around perimeter & pull tab in bottom right corner
GR-B	1	GRAPHIC (B) (47.35 w X 145.61 h total size) 43.35 w X 141.61 h finish size, Dye-sub print on Eclipse Blockout Stretch, single sided, sewn with FCE-2 silicone beading around perimeter & pull tab in bottom right corner
GR-C	1	GRAPHIC (C) (26.95 w X 85.38 h total size) 22.95 w X 81.38 h finish size, Dye-sub print on Eclipse Blockout Stretch, single sided, sewn with FCE-2 silicone beading around perimeter & pull tab in bottom right corner

