

Product	Parts
KIT	Hardware and Graphic (parts 1&2)
Hardware	Hardware only (parts 1)
Graphic only	Graphic Only (part 2)

## Product Parts for HARDWARE

1 - LuminAir Unit Hardware  
 SEE PRODUCT DETAILS



## Product Parts for FABRIC GRAPHIC (details on page 2)

2 - Fabric Graphic

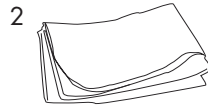

ALL PARTS COME IN THE KIT



## Product Details:

LuminAir Unit Hardware (1) comes zipped closed as a self enclosed soft case handle unit. One zipper is visible when LuminAir Unit is closed. **DO NOT PLUG UNIT IN WHILE IT IS ZIPPED CLOSED.**

When LuminAir Unit Hardware (1) is unzipped you will see (3) zipper units on the bottom of the case and (2) on the top portion.

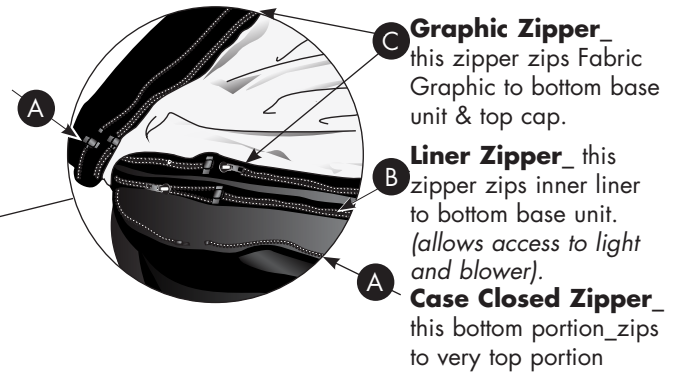

Zippers will be BLACK they are shown here as white for better viewing purposes.

## LIGHTS:

With LuminAir Unit Hardware (1) unplugged and Case unzipped, **A** Unzip the Liner Zipper **B** (the Liner Zipper-2nd zipper up from bottom of base) This will expose the internal Mechanisms.

**WHEN EXPOSING INTERNAL MECHANISMS-MAKE SURE UNIT IS UNPLUGGED-**

\*LED LIGHT COLORS: Red/Green/Blue  
 the light unit goes through a cycle as follows:  
 Medium Speed/ Fast Speed then Slow Speed alternating from all RED to all GREEN to all BLUE then Red & Green to Blue & Green finishing with all 3 colors being displayed.

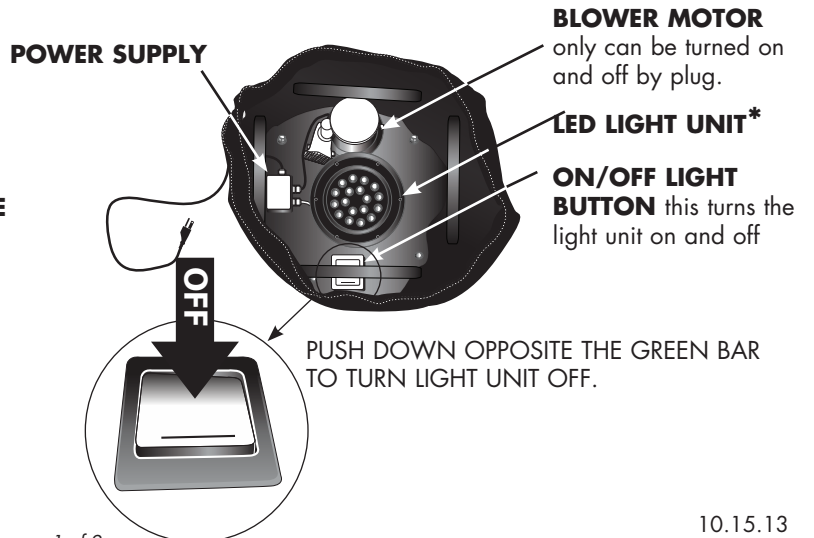

## Display Set-Up

### Step 1

Place LuminAir Unit Hardware (1) at desired **INDOOR** flat location. Unzip LuminAir Unit Hardware (1) to separate the top of the unit from the base.



### Step 2

With Zipper **A** now completely unzipped. Make sure that Inner Liner Zipper **B** is securely zipped shut as well as Fabric Graphic zipper **C**. Now you can plug LuminAir Unit Hardware (1) into the appropriate power supply. (standard 120 outlet)



**BEFORE PLUGGING UNIT IN MAKE SURE LIGHT BUTTON IS TURNED ON/OFF as DESIRED** see Product Detail area on page 1 for information on how to turn lights on/off

### Step 3

After plugging LuminAir Unit Hardware (1) into the power supply. Wait 30 seconds for Unit to inflate. While unit is inflating make sure that it does not get caught on any obstacles.



### Step 4

To Deflate LuminAir Unit Hardware (1), Unplug from the power supply and Wait for Unit to Deflate. Once completely deflated you can now change out the Fabric Graphic (2) or zip Unit shut.



### Removing Fabric Graphic:

To Remove existing Fabric Graphic (2) Unzip both top and bottom Graphic Zipper **C** and slide Fabric Graphic "tube" shape away from Inner Liner. Inner Liner stays secured to the base.

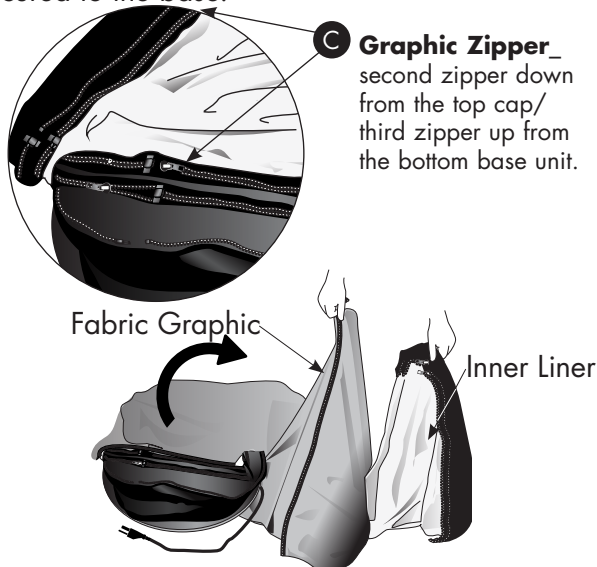

### Attaching a Fabric Graphic:

To attach the Fabric Graphic (2), first make sure original Fabric Graphic is removed and Inner Liner is secured to the base. Slide Fabric Graphic "tube" (2) over Inner Liner "tube" and zip shut around top and bottom perimeter.

**Note:** Make sure inner liner is not twisted or unit will not inflate properly.

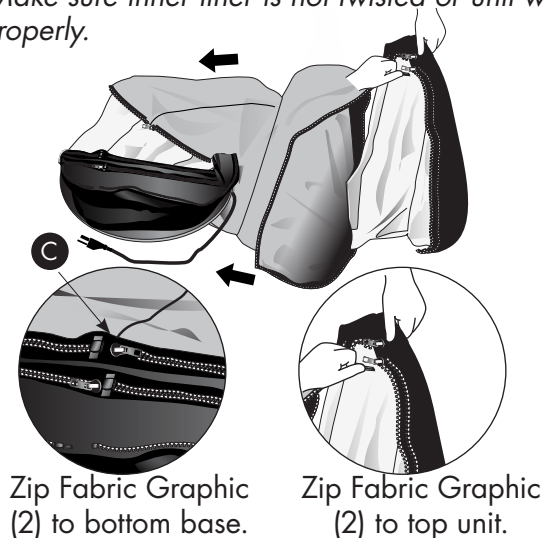

## Storage & Care

See Step 4 for Disassembly. Deflate and zip Unit Shut **A** Store in a cool dry location. **Recommended for indoor use only.** Removed Fabric Graphic (2): Machine wash (cold) on gentle cycle using mild detergent. Line Dry. Do NOT dry clean, Do NOT Iron.

Warranty Information: All products are designed to provide the user with a cost-effective and durable product. Standard warranty is a 'one year parts and labor' warranty which warrants product against defects in material and workmanship. It does not cover damage due to accidents, abuse, or normal wear and tear. Products found to be defective will be replaced or repaired at factory's discretion.