

Quickwall

Complete Kit: Hardware only:
 QWK-B-G QWK-B
 QWK-S-G QWK-S

Create a display on the fly with this easy to assemble, affordable backwall solution that fits in a 10' space. The Quickwall complete kit includes three Mosquito 800 banner stands and a compact, hard molded OCB case.



Available in black

We are continually improving and modifying our product range and reserve the right to vary the specifications without prior notice. All dimensions and weights quoted are approximate and we accept no responsibility for variance. E&OE. See Graphic Templates for graphic bleed specifications.

features and benefits:

Includes three Mosquito 800's

- One Mosquito 800 comes complete with base, pole, snap top rail and bag
- Swivel foot base
- Snap graphic toprail
- 90 day hardware warranty against manufacturer defects

Includes OCB case

- Hard molded, heavy duty banner stand shipping case
- Carry strap included
- Made from 100% recyclable materials
- Variable height
- Protective foam padding
- Made in the USA

dimensions:

Hardware	Graphic
<p>One Mosquito 800: 32" w x 82.87" h x 11.2" d 812.8mm(w) x 2105mm(h) x 285mm(d)</p> <p>Assembled unit: 97" w x 83.75" h x 20" d 2463.8mm(w) x 2127.25mm(h) x 508mm(d)</p> <p>Assembled unit dimension may vary based on angle of stands.</p>	<p>Total visual area: One Mosquito 800: 31.5" w x 78.5" h 800mm(w) x 1994mm(h)</p> <p>Refer to related graphic template for more information.</p> <p>Visit: www.exhibitors-handbook.com/graphic-templates</p>
Shipping	
<p>Shipping dimensions - ships in one box Each box: 40" l x 17" w x 7" h 1016mm(l) x 431.8mm(w) x 177.8mm(h)</p> <p>Approximate shipping weight: 33 lbs / 15 kgs</p>	

additional information:

Graphic materials:
 13 oz flatmaxx vinyl or premium 100% opaque fabric

Recommended spacing: 1.5" between graphics, slightly angled outer stands

- Stands are supplied with clamp rails; which we recommend with Quickwall system

Quickwall Set-Up

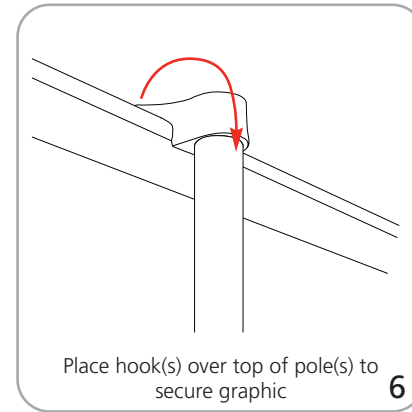
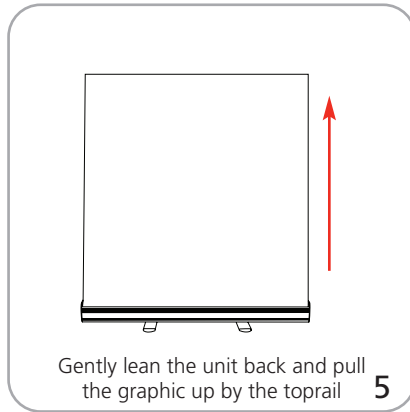
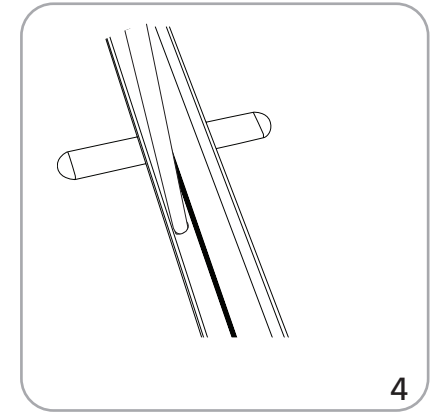
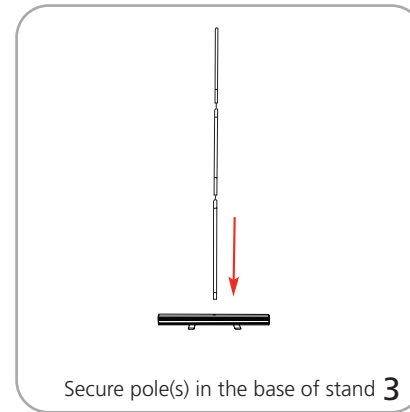
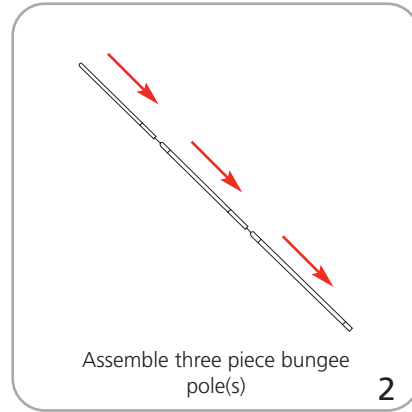
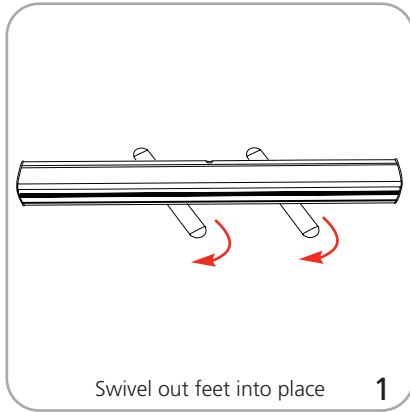

Graphic to toprail attachment

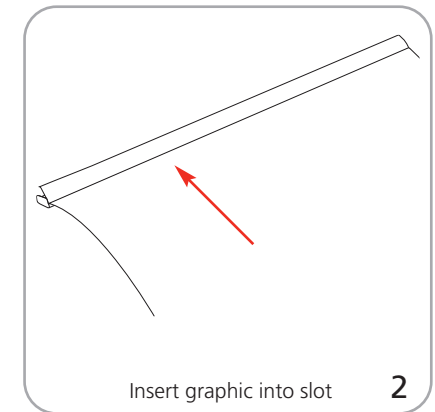
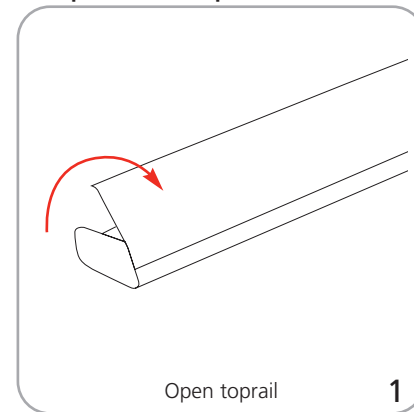

Graphic to base attachment

