

# MODCO 7C - TOWER

MODCO MODULAR EXHIBITS  
 PRODUCT CODE: MODCO7C-TOWER-G



Frame & Graphic



## PRODUCT DESCRIPTION

Modco® Modular Display 7C is a three-dimensional pre-designed tower exhibit booth, ideal for a peninsula booth space. Stylish and lively, this booth is built using tool-free perforated modular aluminum frames along with rounded corners. Multiple size frames connect using tool-less pin connectors.

DISPLAY DIMENSIONS		101"W X 190"H X 101"D	
GRAPHIC SIZES	SIZE	QTY	
	39"W x 190"H	3	
	31"W x 96.25"H	8	
	39"W x 96.25"H	1	
	35.25"W x 94.37"H	1	
TOTAL		13	

## GRAPHIC MATERIAL

Stretch Fabric w/ Integrated Block Out

## GRAPHIC FINISHING

Silicone beading is sewn around the perimeter of the fabric graphic. Silicone beading is hidden from view once installed.

## DISPLAY CONSTRUCTION

Aluminum frame and components

## SHIPPING WEIGHTS & DIMENSIONS (FREIGHT ONLY)

Shipping Weight	954lbs w/ crate
Shipping Dimensions	102"L x 45"W x 58"H

## GRAPHIC TURN AROUND TIME

4 business days after proof approval

AVAILABILITY	PFC / PA
--------------	----------

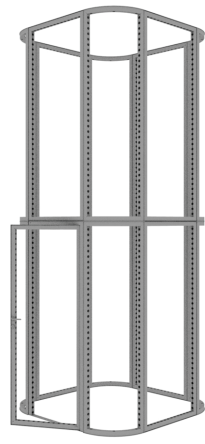

## PARTS REFERENCE

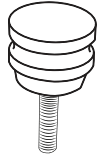

**Pin Connector**  
MOD-PC  
Qty.16

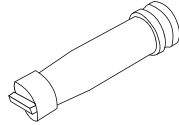

**Door Clamp Connector**  
MOD-DCC-180D Qty.6

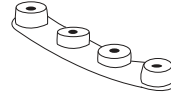

**180° Curved Connector**  
MOD-CRV-180DCL Qty.8

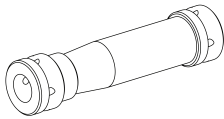

**Clamp Connector**  
MOD-CLA-CON  
Qty.42

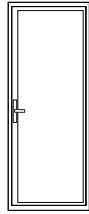

**95" Door**  
MOD-DSWL-992x2418  
Qty.1

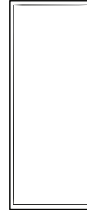

**992 x 2418**  
MOD-FRM-992x2418  
Qty.7



**774 x 2418 Curved**  
MOD-CRVFRM-774x992  
Qty.8

### Parts List Key

#### FRAMES

REF #	QTY	PART NO.	DESCRIPTION
1	7	MOD-FRM-992x2418	Straight Frame, Corner Screw Connect 992mm x 2418mm
2	1	MOD-DSWL-992x2418	Door Set w/ Lock 992mm x 2418mm
3	8	MOD-CRVFRM-774x2418	1/4 Curved Frame, welded 774mm x 2418mm

#### CONNECTORS, ACCESSORIES & COVER PROFILES

REF #	QTY	PART NO.	DESCRIPTION
B	16	MOD-PC	Pin Connector
D	42	MOD-CLA-CON	Clamp Connector
E	6	MOD-DCC-180D	Door Clamp Connector, 180 Degrees (Connect to Wall Frame)
G	56	MOD-FP	Modco Frame Protector
I	8	MOD-CRV-180DCL	Modco Curve 180 Degree Connector (Left)

## INSTRUCTIONS

- Continue around to complete perimeter

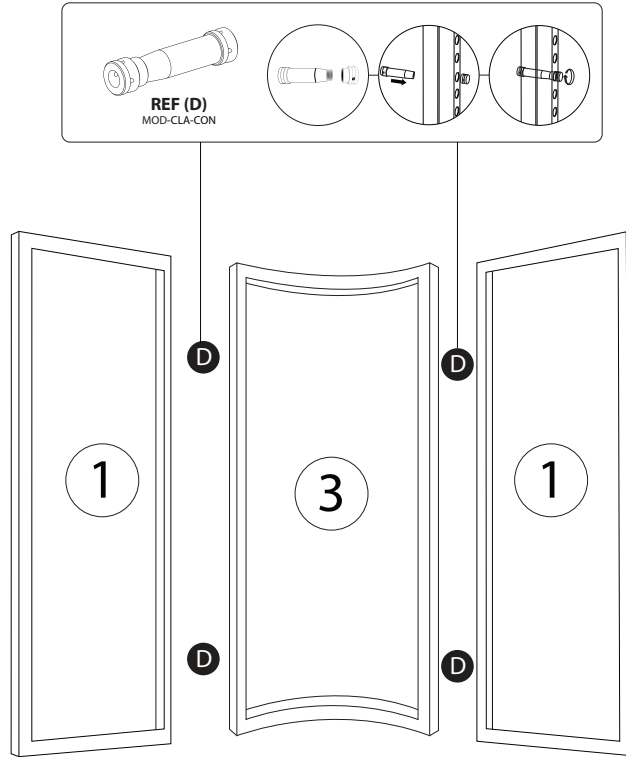

- Respective to Door only

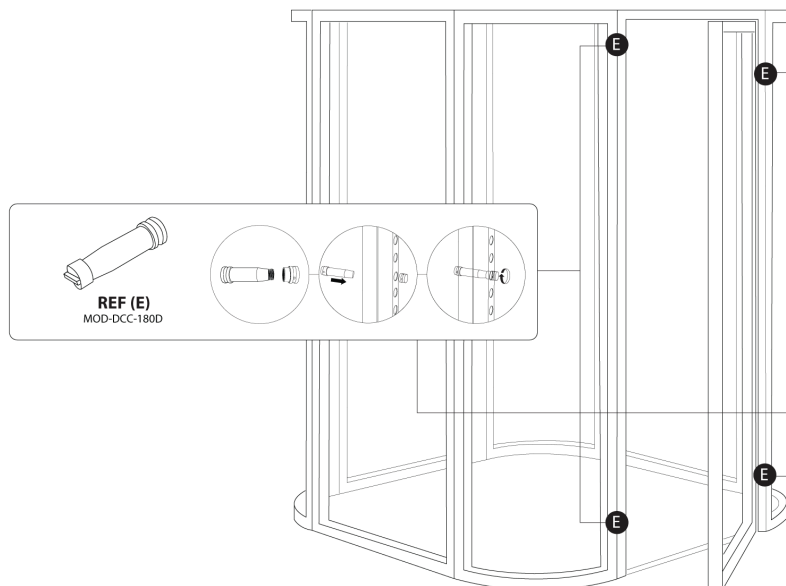

# MODCO 7C - TOWER

MODCO MODULAR EXHIBITS

PRODUCT CODE: MODCO7C-TOWER-G



INDOOR USE



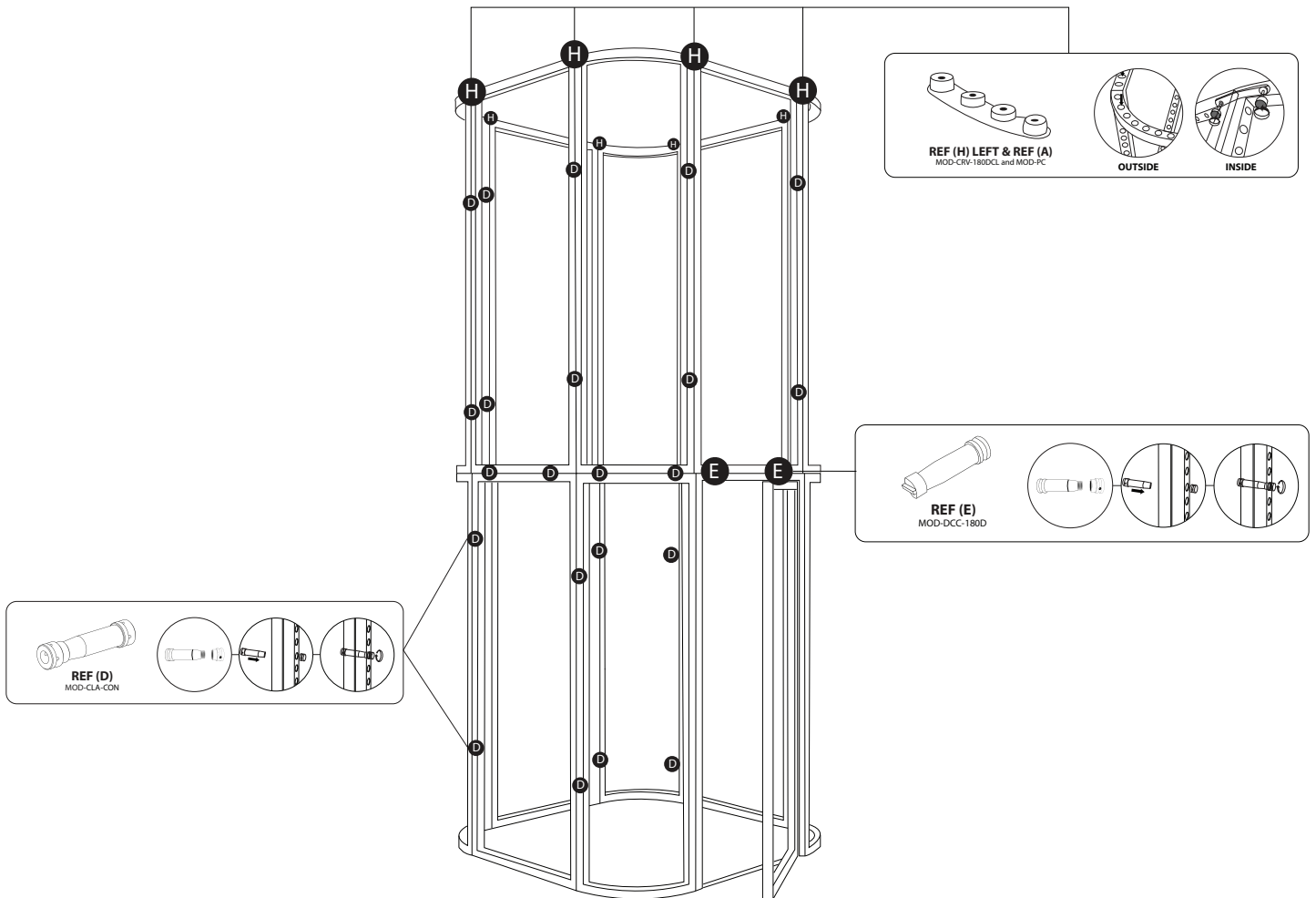

Frame & Graphic

## INSTRUCTIONS

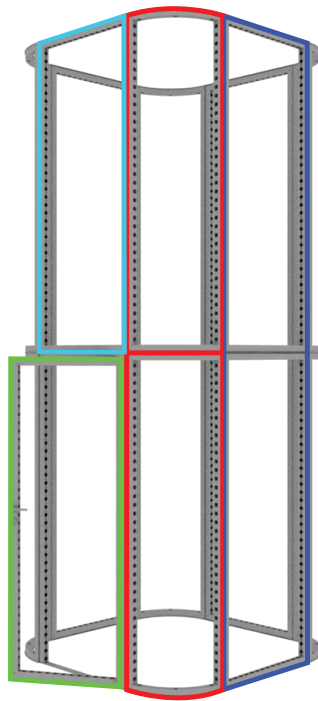

## GRAPHIC REFERENCES



-  - 992 x 4836 - Qty.3
-  - 774 x 2418 - Qty.8
-  - 992 x 2418 - Qty.1
-  - 992 x 2418 DOOR - Qty.1



Place graphic over the front of the frame.



Begin inserting SEG beading at each corner.

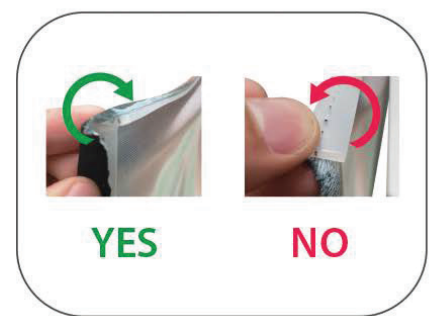

Insert the silicone beading with the fabric folded over. The silicone beading should not be exposed.

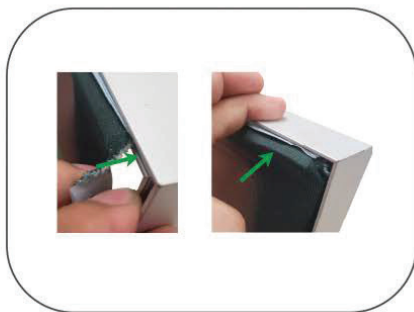

Using your fingers, push both fabric and silicone beading completely into the extrusions channel.

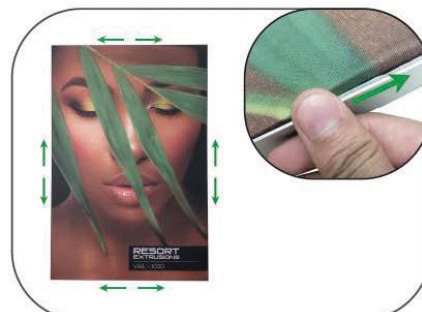

Continue to push in the remaining silicone beading on each side.



Check the perimeter of the frame for any excess beading that hasn't been pushed in. Graphic should be taut.