

# LUMIÈRE CONFIGURATION - F (NO LIGHTS)

LUMIÈRE LIGHT WALL

PRODUCT CODE: LLW20X15FNL



On frame On graphic

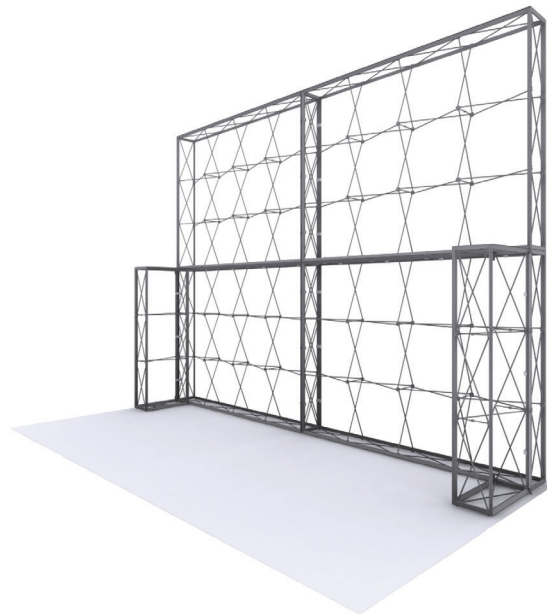

Straight Connector



L Link Connector

## PRODUCT DESCRIPTION

Introducing the Lumiere Light Wall! A combination of innovative silicone-edge graphics and RPL fabric pop ups offers an easier and more cost effective SEG option. This SEG style display has the depth of the RPL so you can expose more of your message using endcap graphics. The Lumiere shrinks down in size - simply collapse the geometric frame and the SEG bungeed channel bars, and fold or roll the fabric graphics. Setup can be done by 1 person and in 5-10 minutes. SEG portability is easy and stylish.

**DISPLAY DIMENSION** 236.2" W x 177" H x 44.5" D

## GRAPHIC DIMENSIONS

**4X3 MAIN GRAPHICS** 118.5" W x 89" H (8 Graphics)

**4X3 END CAP GRAPHICS** 14.25" W x 89" H (4 Graphics)

**1X3 MAIN GRAPHICS** 30.5" W x 89" H (4 Graphics)

**1X3 END CAP GRAPHICS** 14.25" W x 89" H (2 Graphics)

## FRAME CONFIGURATION QUANTITY

**4X3 FRAME** 4 Frames

**1X3 FRAME** 2 Frames

## GRAPHIC MATERIAL

Stretch Fabric

## GRAPHIC FINISHING

Silicone beading is sewn around the perimeter of the fabric graphic. Silicone beading is hidden from view once installed.

## DISPLAY CONSTRUCTION

Aluminum Frame

## SHIPPING WEIGHTS & DIMENSIONS

4x3 Lumiere Light Wall (4 boxes total)

**Shipping Weight** 35 lbs (frame only) (each box)  
39 lbs (with graphics) (each box)

**Shipping Dimensions** 34" L x 14" W x 9" H (each box)

1x3 Lumiere Light Wall (2 boxes total)

**Shipping Weight** 20 lbs (frame only) (each box)  
24 lbs (with graphics) (each box)

**Shipping Dimensions** 34" L x 14" W x 9" H (each box)

## GRAPHIC TURN AROUND TIME

6 business days after proof approval

**AVAILABILITY** CA and PA

# LUMIÈRE CONFIGURATION - F (NO LIGHTS)

LUMIÈRE LIGHT WALL  
PRODUCT CODE: LLW20X15FNL

## AVAILABLE ACCESSORIES



Lumiere Front Lit -  
Black Light LED



Lumiere Front Lit -  
Silver Light LED



Lumiere Black Light  
(150 W)



Lumiere Silver Light  
(150 W)



T135 LED Light



LED Light Bracket



Qty 4 -Stabilization Feet

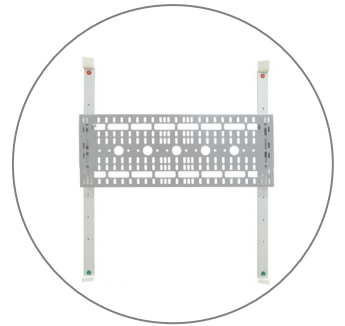

Monitor Bracket

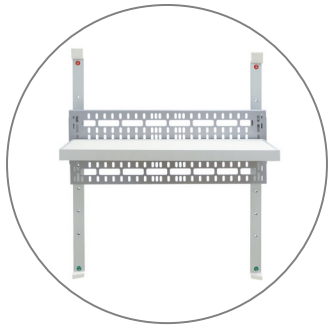

Shelf



La Caja Case



Tahoe Case



Hard Case Podium



Medium Hard Case



Half Hard Case



Genie Counter Case

# LUMIÈRE CONFIGURATION - F (NO LIGHTS)

LUMIÈRE LIGHT WALL  
PRODUCT CODE: LLW20X15FNL

## PARTS LIST



Qty 4 - 4x3 Pop Up Frame



Qty 2 - 1x3 Pop Up Frame



Qty 16 - 4 Section Channel Bars



Qty 24 - 3 Section Channel Bars



Qty 8 - 1 Section Channel Bars

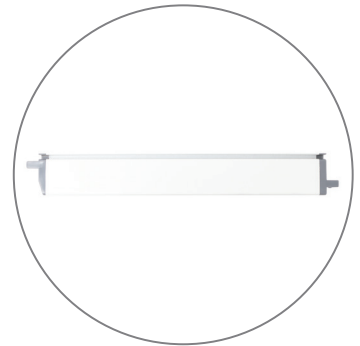

Qty 24 - End Cap Channel Bars



Qty 6 - Carry Bag



Qty 6 - Channel Bar Bag



Qty 28 - Straight Connector



Qty 6 - L Link Connector

# LUMIÈRE CONFIGURATION - F (NO LIGHTS)

LUMIÈRE LIGHT WALL

PRODUCT CODE: LLW20X15FNL

## SET UP INSTRUCTIONS

### Set Up Pop Up Frame



**a.** Place frame with the adjustable feet facing down.

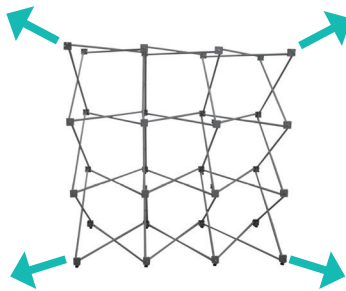

**b.** Expand the frame.

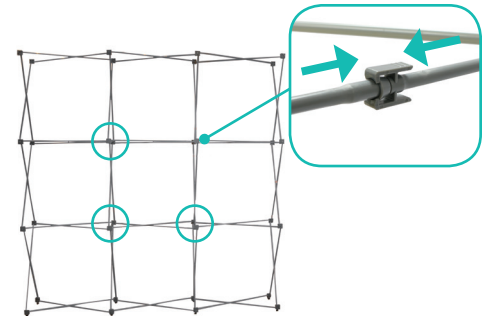

**c.** Close frame by pushing the outside of the frame until male and female ends connect.

### Insert Channel Bars

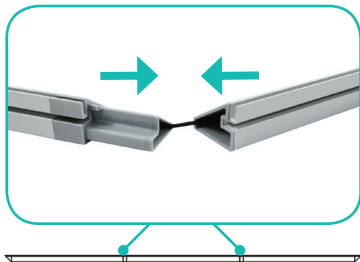

**a.** Expand each channel bar. Follow bungee to connect.

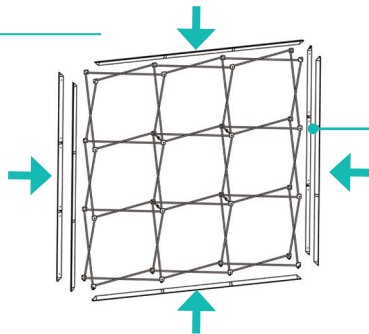

**b.** Attach channel bars to frame.

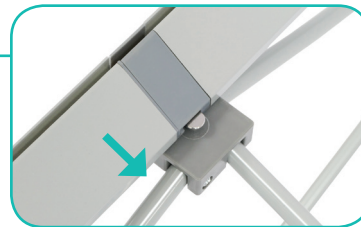

**c.** Slide channels bars onto frame, from top to bottom, then secure onto metal peg.



**d.** Attach the top and bottom end-caps on each side of the frame.

### Install Graphic



**a.** In each corner, insert the silicone edge beading into the groove.



**b.** Then insert the remainder of the beading.



**c.** Repeat graphic installation on the end caps.

### Optional Accessories

#### Light Bracket:

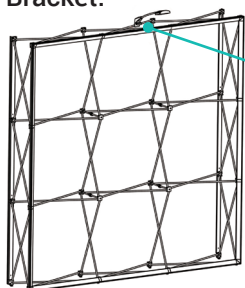

**a.** Snap the LED Light Bracket on top of the frame. Then slide the LED Light onto the bracket.



#### Stabilized Feet:

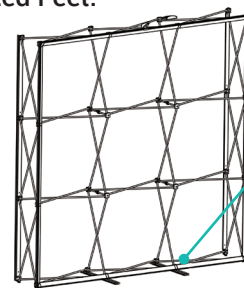

**a.** From the back, lift frame and insert adjustable feet onto stabilized feet. Then slide stabilized feet toward and insert onto the adjustable feet.

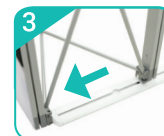
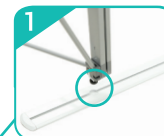

# LUMIÈRE CONFIGURATION - F (NO LIGHTS)

LUMIÈRE LIGHT WALL  
PRODUCT CODE: LLW20X15FNL

## SET UP INSTRUCTIONS

### Connecting Wall

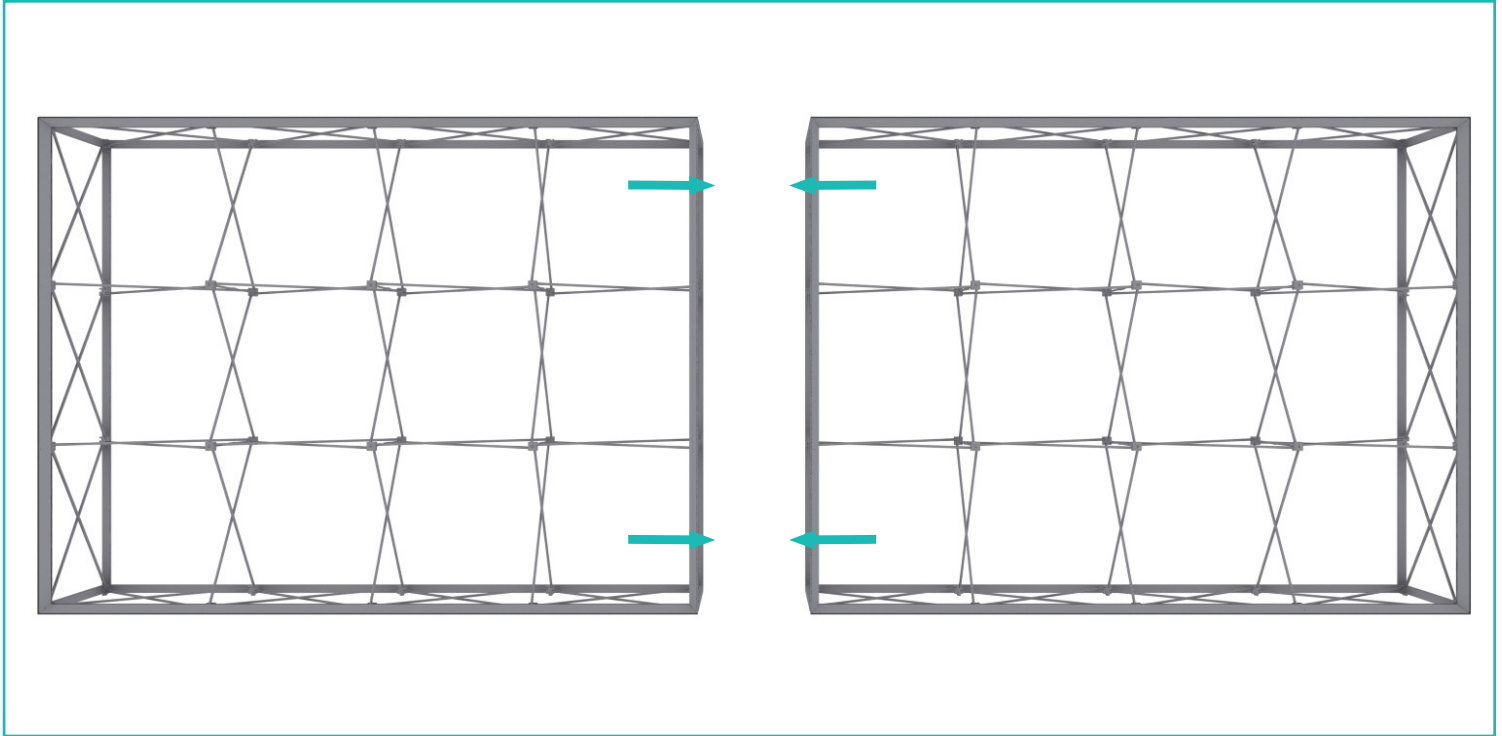

Place the (2) 4x3 frames side by side.

**Note:** Rendering shown without graphics for clarity.

### Straight Connection



**1**  
\*Starting from behind, make sure the frames are flushed next to each other.

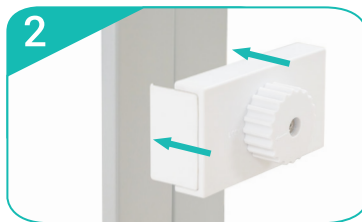

**2**  
Slide Straight Connector onto the channel bars of both frames.

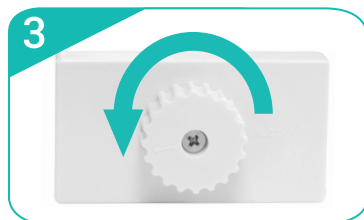

**3**  
Turn dial to the left to lock the Straight Connector in place. Repeat for each vertical sections (6 total).

**Note:** Repeat process when frames are stack together (6 total).



**4**

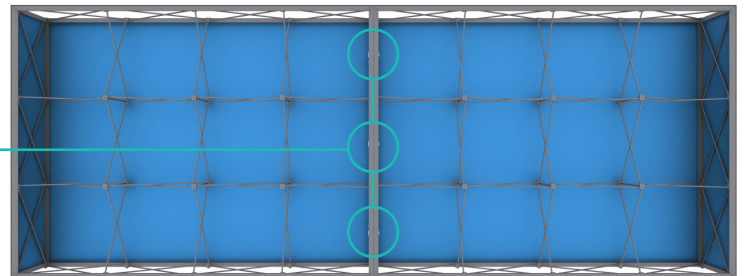

\*Back side of the 4x3's shown above.

# LUMIÈRE CONFIGURATION - F (NO LIGHTS)

LUMIÈRE LIGHT WALL

PRODUCT CODE: LLW20X15FNL

## SET UP INSTRUCTIONS

### Connecting Top Walls

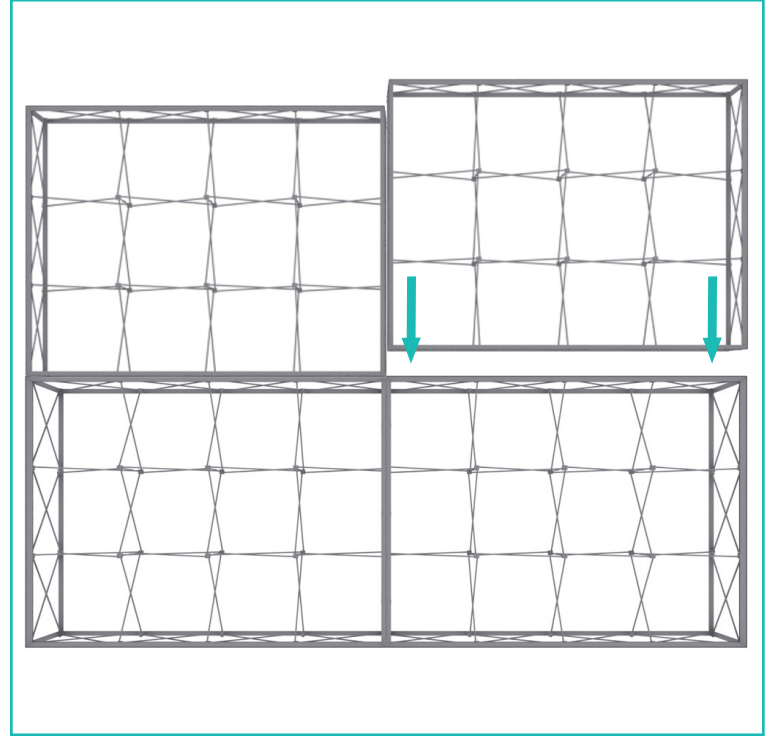
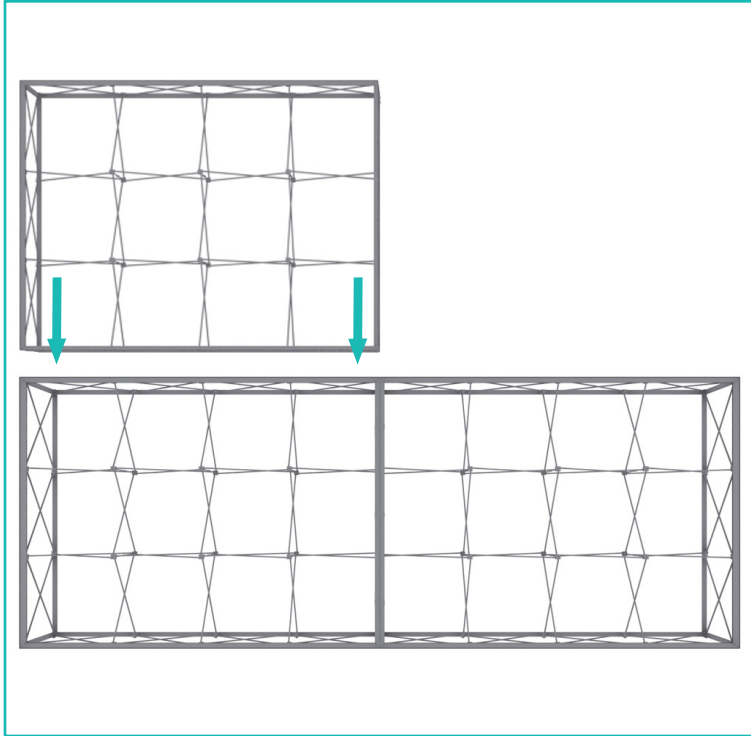

Place the 4x3 frames on top of the 4x3 frames.

**Note:** 2 people are required to hold each side of the top frame while the third person secures with the Straight Connectors. Repeat process for other top frame.

**Note:** Rendering shown without graphics for clarity. 4x3 front side graphics must be installed first before placing the frames on top.

### Straight Connection



\*Starting from behind, make sure the frames are flushed next to each other.

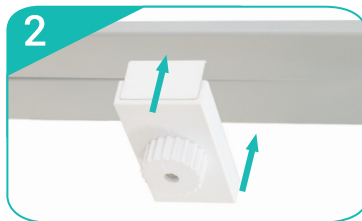

Slide Straight Connector onto the channel bars of both frames.

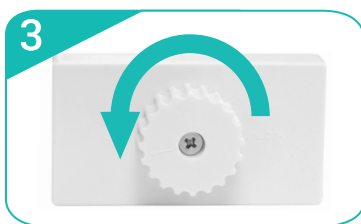

Turn dial to the left to lock the Straight Connector in place. Repeat for each vertical sections (8 total).

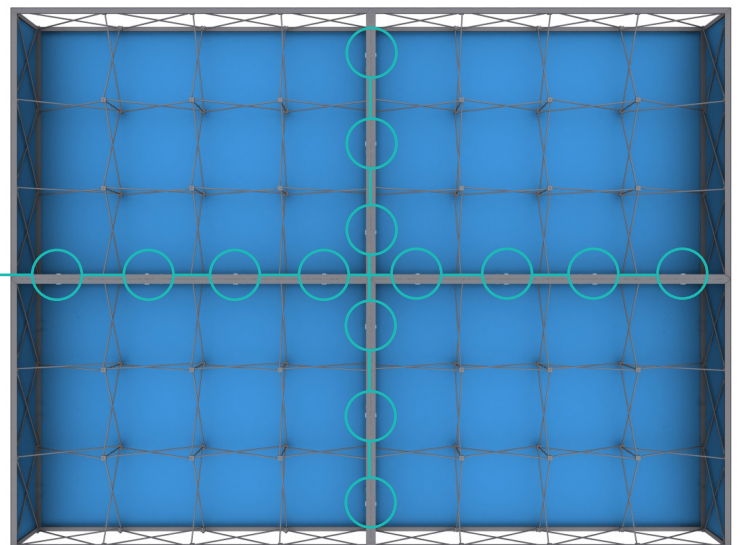

\*Back side of the stacked 4x3 frames shown above.

# LUMIÈRE CONFIGURATION - F (NO LIGHTS)

LUMIÈRE LIGHT WALL  
PRODUCT CODE: LLW20X15FNL

## SET UP INSTRUCTIONS

### Connecting Return Walls

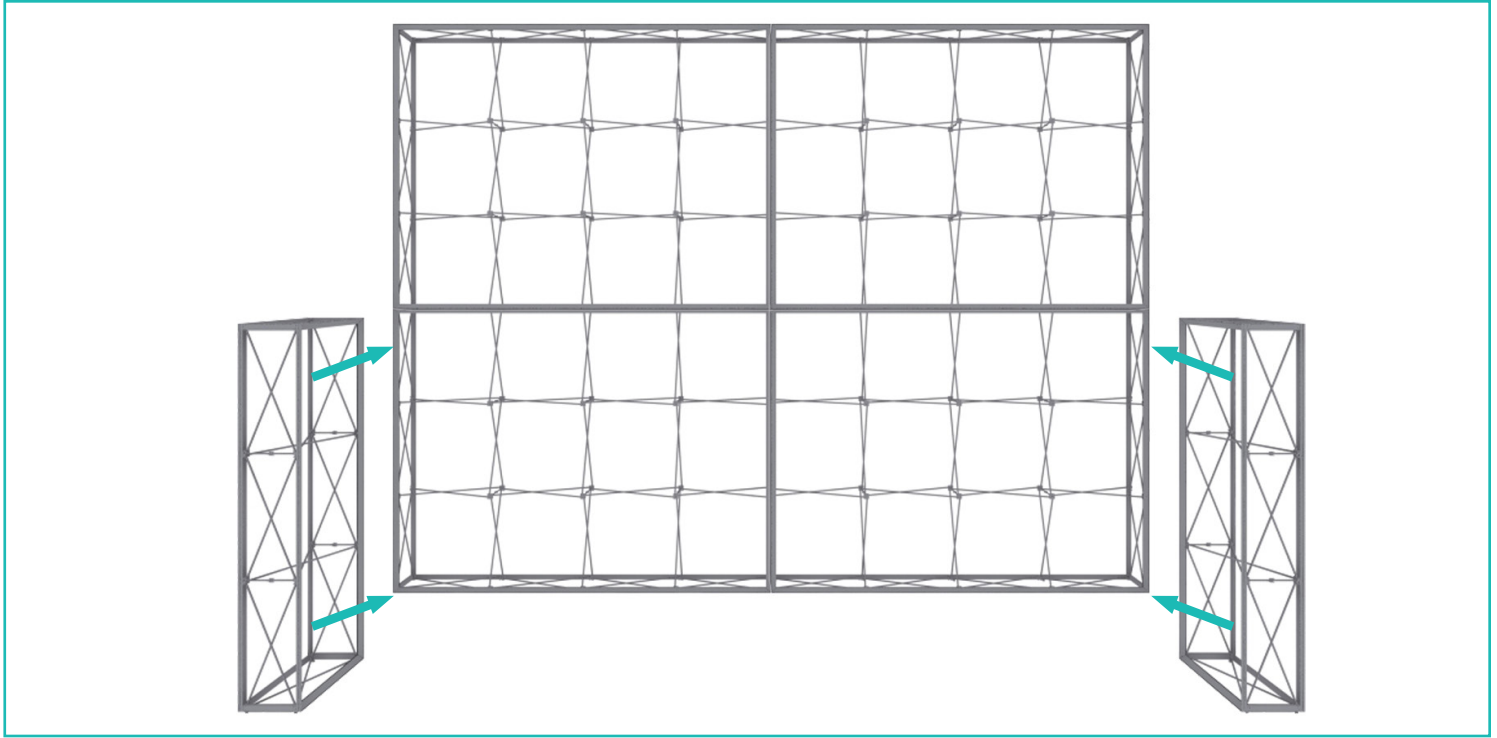

Adjoin the 1x3 frame perpendicular (90° angle) to the front side of the 4x3 frame.

**Note:** Rendering shown without graphics for clarity. 4x3 front side graphic must be installed before connecting frames.

### L Link Connection



\*Starting from behind, pull the 4x3 graphic away to make space for L Connector.



Slide L Connector onto the channel bars of both frames.

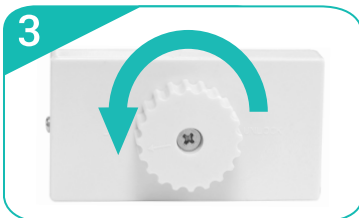

Turn dial to the left to lock the L Connector in place. Repeat for each vertical section (6 total).

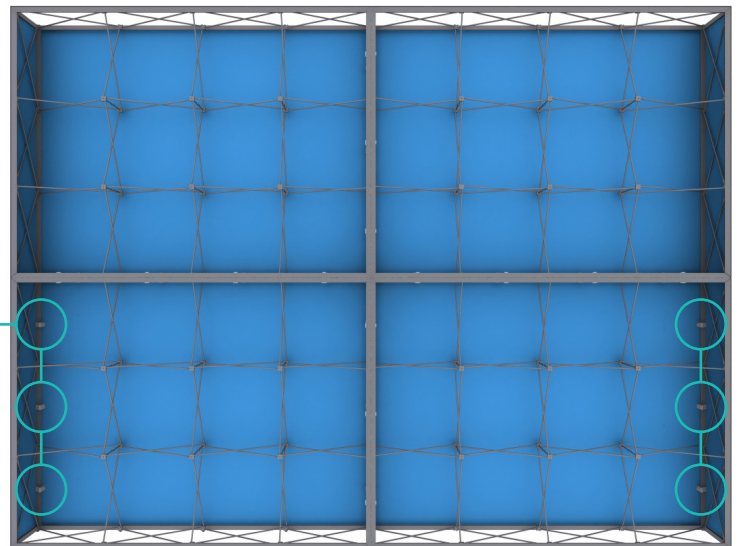

\*Back side of 4x3 shown above.

# LUMIÈRE CONFIGURATION - F (NO LIGHTS)

LUMIÈRE LIGHT WALL

PRODUCT CODE: LLW20X15FNL

## TEMPLATE GUIDE

### Front View

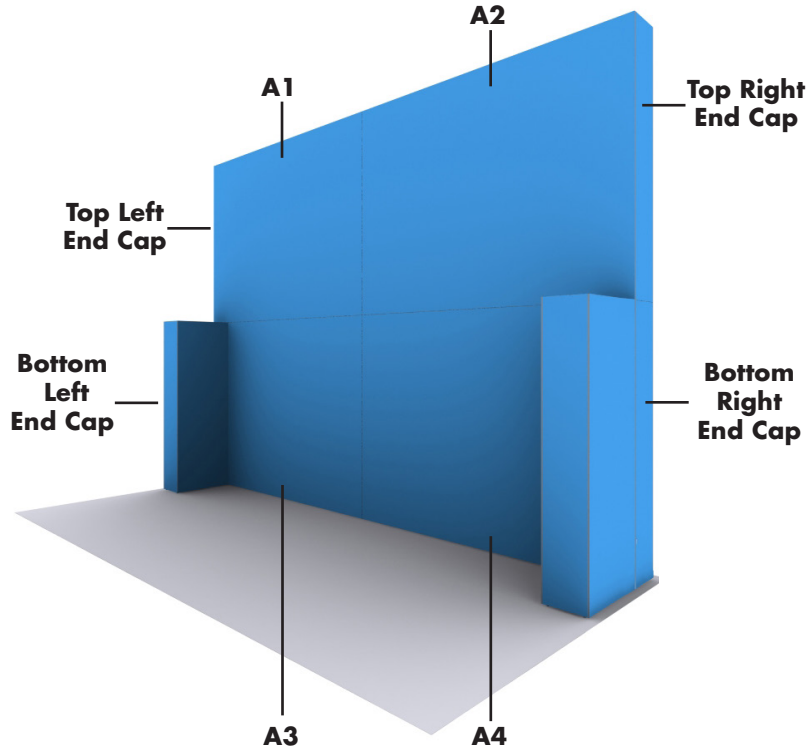

<p><b>TOP LEFT END CAP</b></p>	<p><b>A1 - LUMIÈRE CONFIGURATION F (4x3 TOP LEFT FRONT GRAPHIC)</b> Non-Backlit / Backlit</p> <p>Print Size (with bleed): 118.5" x 89" Yellow Safe Area: 112.5" x 83.5" Finished Size: 117.5" x 88" End Cap Print Size (with bleed): 14.25" x 89" End Cap Yellow Safe Area: 9.5" x 83.5" Finished Size: 13.375" x 88"</p> <p>Keep all your important graphics within top, left, and center dimensions in the yellow safe zone. Blue area will print.</p> <p><b>DISCLAIMER:</b> Any continuous artwork may not line up properly. <b>TEMPLATE ARE AT 1/2 SCALE</b></p>	<p><b>A2 - LUMIÈRE CONFIGURATION F (4x3 TOP RIGHT FRONT GRAPHIC)</b> Non-Backlit / Backlit</p> <p>Print Size (with bleed): 118.5" x 89" Yellow Safe Area: 112.5" x 83.5" Finished Size: 117.5" x 88" End Cap Print Size (with bleed): 14.25" x 89" End Cap Yellow Safe Area: 9.5" x 83.5" Finished Size: 13.375" x 88"</p> <p>Keep all your important graphics within top, right, and center dimensions in the yellow safe zone. Blue area will print.</p> <p><b>DISCLAIMER:</b> Any continuous artwork may not line up properly. <b>TEMPLATE ARE AT 1/2 SCALE</b></p>	<p><b>TOP RIGHT END CAP</b></p>
<p><b>BOTTOM LEFT END CAP</b></p>	<p><b>A3 - LUMIÈRE CONFIGURATION F (4x3 BOTTOM LEFT FRONT GRAPHIC)</b> Non-Backlit / Backlit</p> <p>Print Size (with bleed): 118.5" x 89" Yellow Safe Area: 98" x 83.5" Finished Size: 117.5" x 88" End Cap Print Size (with bleed): 14.25" x 89" End Cap Yellow Safe Area: 9.5" x 83.5" Finished Size: 13.375" x 88"</p> <p>Keep all your important graphics within top, left, and center dimensions in the yellow safe zone. Blue area will print.</p> <p><b>DISCLAIMER:</b> Any continuous artwork may not line up properly. <b>TEMPLATE ARE AT 1/2 SCALE</b></p>	<p><b>A4 - LUMIÈRE CONFIGURATION F (4x3 BOTTOM RIGHT FRONT GRAPHIC)</b> Non-Backlit / Backlit</p> <p>Print Size (with bleed): 118.5" x 89" Yellow Safe Area: 98" x 83.5" Finished Size: 117.5" x 88" End Cap Print Size (with bleed): 14.25" x 89" End Cap Yellow Safe Area: 9.5" x 83.5" Finished Size: 13.375" x 88"</p> <p>Keep all your important graphics within top, right, and center dimensions in the yellow safe zone. Blue area will print.</p> <p><b>DISCLAIMER:</b> Any continuous artwork may not line up properly. <b>TEMPLATE ARE AT 1/2 SCALE</b></p>	<p><b>BOTTOM RIGHT END CAP</b></p>



# LUMIÈRE CONFIGURATION - F (NO LIGHTS)

LUMIÈRE LIGHT WALL

PRODUCT CODE: LLW20X15FNL

## TEMPLATE GUIDE

### Back View

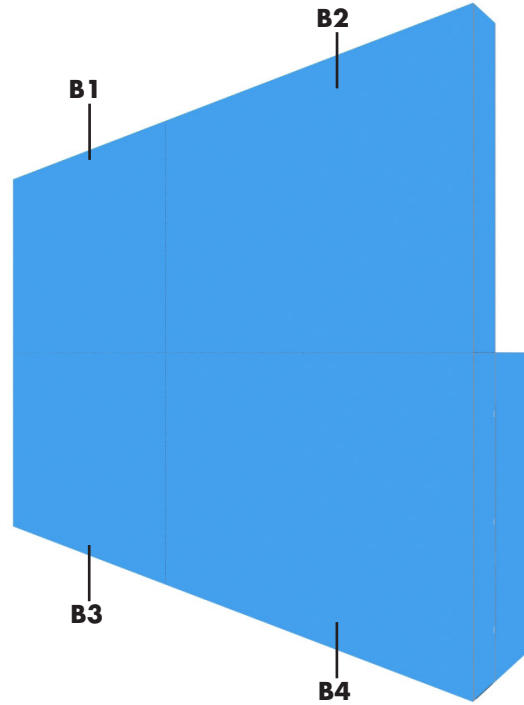

#### B1 - LUMIERE CONFIGURATION F (4x3 TOP LEFT BACK GRAPHIC) Non-Backlit / Backlit

Print Size (with bleed): 118.5" x 89"  
Yellow Safe Area: 112.5" x 83.5"  
Finished Size: 117.5" x 88"  
End Cap Print Size (with bleed): 14.25" x 89"  
End Cap Yellow Safe Area: 9.5" x 83.5"  
Finished Size: 13.375" x 88"

Keep all your important graphics  
(such as logos, text, and contact information)  
in the yellow safe zone.  
Blue area will print

**DISCLAIMER:**  
Any continuous artwork may not line up properly  
**TEMPLATE ARE AT 1/2 SCALE**

#### B2 - LUMIERE CONFIGURATION F (4x3 TOP RIGHT BACK GRAPHIC) Non-Backlit / Backlit

Print Size (with bleed): 118.5" x 89"  
Yellow Safe Area: 112.5" x 83.5"  
Finished Size: 117.5" x 88"  
End Cap Print Size (with bleed): 14.25" x 89"  
End Cap Yellow Safe Area: 9.5" x 83.5"  
Finished Size: 13.375" x 88"

Keep all your important graphics  
(such as logos, text, and contact information)  
in the yellow safe zone.  
Blue area will print

**DISCLAIMER:**  
Any continuous artwork may not line up properly  
**TEMPLATE ARE AT 1/2 SCALE**

#### B3 - LUMIERE CONFIGURATION F (4x3 BOTTOM LEFT BACK GRAPHIC) Non-Backlit / Backlit

Print Size (with bleed): 118.5" x 89"  
Yellow Safe Area: 112.5" x 83.5"  
Finished Size: 117.5" x 88"  
End Cap Print Size (with bleed): 14.25" x 89"  
End Cap Yellow Safe Area: 9.5" x 83.5"  
Finished Size: 13.375" x 88"

Keep all your important graphics  
(such as logos, text, and contact information)  
in the yellow safe zone.  
Blue area will print

**DISCLAIMER:**  
Any continuous artwork may not line up properly  
**TEMPLATE ARE AT 1/2 SCALE**

#### B4 - LUMIERE CONFIGURATION F (4x3 BOTTOM RIGHT BACK GRAPHIC) Non-Backlit / Backlit

Print Size (with bleed): 118.5" x 89"  
Yellow Safe Area: 112.5" x 83.5"  
Finished Size: 117.5" x 88"  
End Cap Print Size (with bleed): 14.25" x 89"  
End Cap Yellow Safe Area: 9.5" x 83.5"  
Finished Size: 13.375" x 88"

Keep all your important graphics  
(such as logos, text, and contact information)  
in the yellow safe zone.  
Blue area will print

**DISCLAIMER:**  
Any continuous artwork may not line up properly  
**TEMPLATE ARE AT 1/2 SCALE**

# LUMIÈRE CONFIGURATION - F (NO LIGHTS)

LUMIÈRE LIGHT WALL

PRODUCT CODE: LLW20X15FNL

## TEMPLATE GUIDE

### Front View

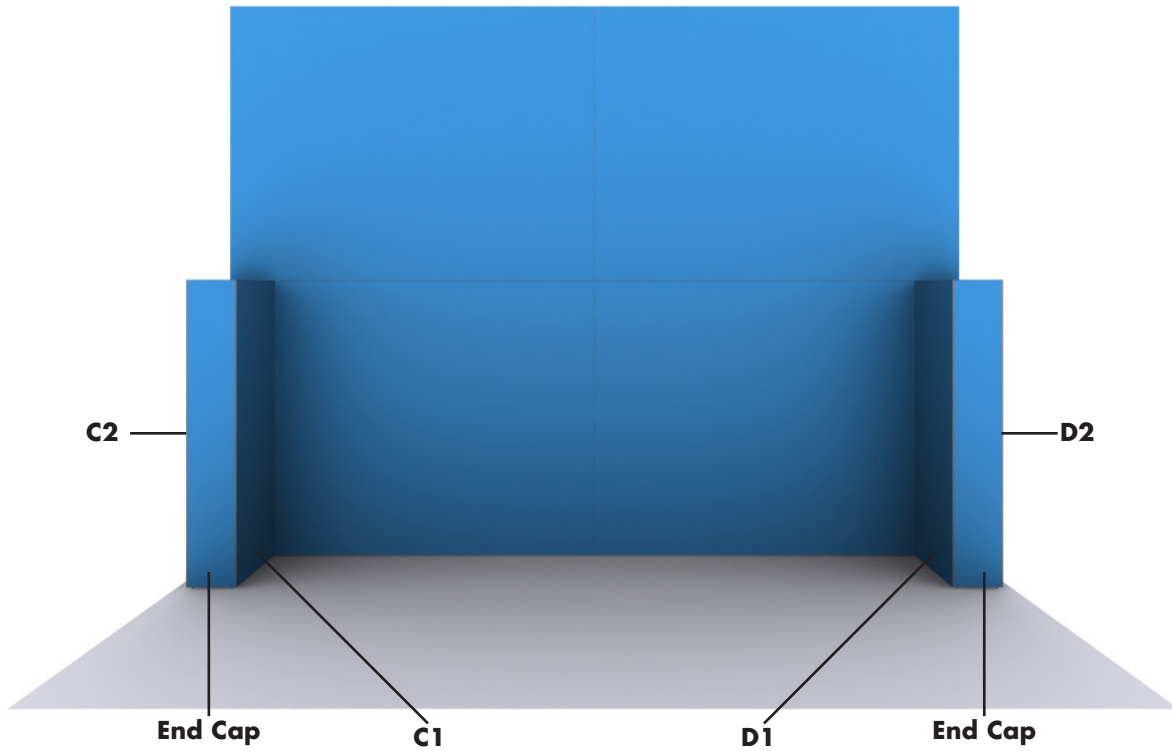

<p><b>C2 - LUMIERE CONFIGURATION F (1x3 LEFT RETURN WALL GRAPHIC) Non-Backlit / Backlit</b></p> <p>Print Size (with bleed): 31.5" x 89" Yellow Safe Area: 25.5" x 83.5" Finished Size: 30.5" x 88" End Cap Print Size (with bleed): 14.25" x 89" End Cap Yellow Safe Area: 9.5" x 83.5" Finished Size: 13.375" x 88"</p> <p>Keep all your important graphics such as logos, text, and contact information in the yellow safe zone. Blue area will print</p> <p><b>DISCLAIMER:</b> Any continuous artwork may not line up properly</p> <p><b>TEMPLATE ARE AT 1/2 SCALE</b></p>	<p><b>END CAP</b></p>	<p><b>C1 - LUMIERE CONFIGURATION F (1x3 LEFT RETURN WALL GRAPHIC) Non-Backlit / Backlit</b></p> <p>Print Size (with bleed): 31.5" x 89" Yellow Safe Area: 25.5" x 83.5" Finished Size: 30.5" x 88" End Cap Print Size (with bleed): 14.25" x 89" End Cap Yellow Safe Area: 9.5" x 83.5" Finished Size: 13.375" x 88"</p> <p>Keep all your important graphics such as logos, text, and contact information in the yellow safe zone. Blue area will print</p> <p><b>DISCLAIMER:</b> Any continuous artwork may not line up properly</p> <p><b>TEMPLATE ARE AT 1/2 SCALE</b></p>
---	-----------------------	---

Ver-1011.17

<p><b>D1 - LUMIERE CONFIGURATION F (1x3 RIGHT RETURN WALL GRAPHIC) Non-Backlit / Backlit</b></p> <p>Print Size (with bleed): 31.5" x 89" Yellow Safe Area: 25.5" x 83.5" Finished Size: 30.5" x 88" End Cap Print Size (with bleed): 14.25" x 89" End Cap Yellow Safe Area: 9.5" x 83.5" Finished Size: 13.375" x 88"</p> <p>Keep all your important graphics such as logos, text, and contact information in the yellow safe zone. Blue area will print</p> <p><b>DISCLAIMER:</b> Any continuous artwork may not line up properly</p> <p><b>TEMPLATE ARE AT 1/2 SCALE</b></p>	<p><b>END CAP</b></p>	<p><b>D2 - LUMIERE CONFIGURATION F (1x3 RIGHT RETURN WALL GRAPHIC) Non-Backlit / Backlit</b></p> <p>Print Size (with bleed): 31.5" x 89" Yellow Safe Area: 25.5" x 83.5" Finished Size: 30.5" x 88" End Cap Print Size (with bleed): 14.25" x 89" End Cap Yellow Safe Area: 9.5" x 83.5" Finished Size: 13.375" x 88"</p> <p>Keep all your important graphics such as logos, text, and contact information in the yellow safe zone. Blue area will print</p> <p><b>DISCLAIMER:</b> Any continuous artwork may not line up properly</p> <p><b>TEMPLATE ARE AT 1/2 SCALE</b></p>
--	-----------------------	--

Ver-1011.17