

Product Parts

- 1 - Base
- 2 - Banner Rail (x2)
- 3 - Shock Cord Pole
- 4 - Feet (x2)
- 4a - Buckle
- 5 - Pin (x2)



***Do Not Pull Pins Until Directed**



Banner Install

Step 1

Remove all of the product parts from the bag and place, along with the banner, on a clean flat surface. Remove both End Caps (A) from the Banner Rail (2) and snap the Banner Rail (2) open. Fully insert the top edge of the Banner into the groove of the Banner Rail (2) and snap it shut. Replace end caps.

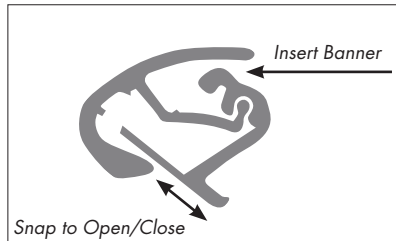
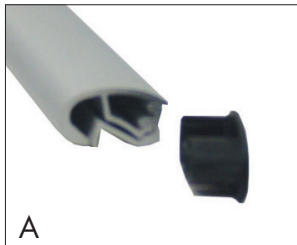

Step 2

Lay the banner flat, printed side up. On the Base (1) remove the strip of protective paper to expose the adhesive. Press the bottom of the banner onto the adhesive, and to smooth out any bubbles or wrinkles.

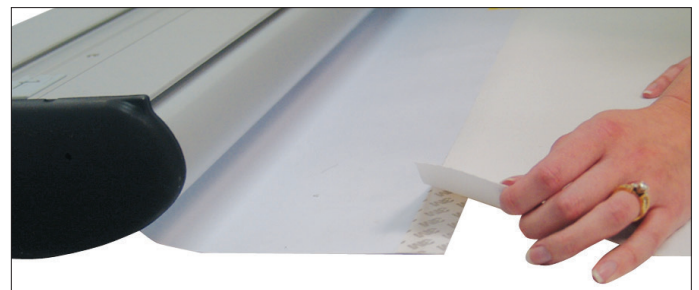

Step 3

Maintain tension on the banner while slowly removing the Pin (4). Allow the banner to gently roll into the canister.



Save the pin in the pin holder on the bottom of the Base (1) for future graphic changes.



Repeat steps 1-3 to install a 2nd banner on the other side.

Step 4

Once the banner has been fully retracted into the Base, simply place the display in the carrying case until you are ready for display set-up.

Display Set-Up

Step 1

Insert the notch on the center of each of the Feet (4) to the receptacles on the bottom of the Base (1).

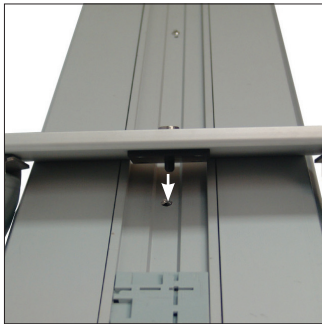

Step 2

Slide the inside of the Buckle (4a) into the groove on each side of the Base (1). Press the top of the Buckle (4) down to secure the Feet (4) into place.

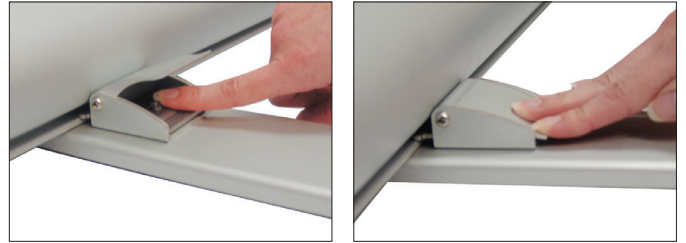

Step 3

Connect the Shock Cord Pole (3) sections together and insert the spring end of the Shock Corded Pole (3) into the pole receptacle on the Base (1).



Step 4

Stand facing the back of the Base and gently pull the Banner Rail (2) upwards. Connect the back of the Banner Rail (2) into the top of the Shock Cord Pole (3).

Repeat step 4 to display a 2nd banner on the other side.



Storage

Place all product parts into Carry Cases and store in a cool dry location.



Care

To clean, wipe with damp cloth.

Warranty Information: All products are designed to provide the user with a cost-effective and durable product. Standard warranty is a 'one year parts and labor' warranty which warrants product against defects in material and workmanship. It does not cover damage due to accidents, abuse, or normal wear and tear. Products found to be defective will be replaced or repaired at factory's discretion.