

10FT EZ TUBE STRAIGHT 30mm

SETUP INSTRUCTIONS

A. Horizontal / Vertical frame Tubing

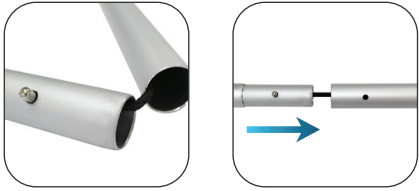

The main frame tubing and support bar are multi-piece units, connected with an internal bungee cord. Connect all of them together using the push caps and lay them to the side.

B. Bottom Corner / Feet



Attach each foot to a bottom corner base using a bolt and washer.

C. Bottom Corner / Horizontal and Vertical Tube

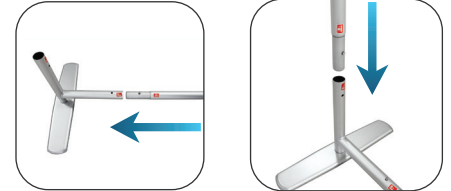

Attach each bottom corner base to each side of a horizontal and vertical frame tube. Each end is conveniently marked with a letter/number decal.

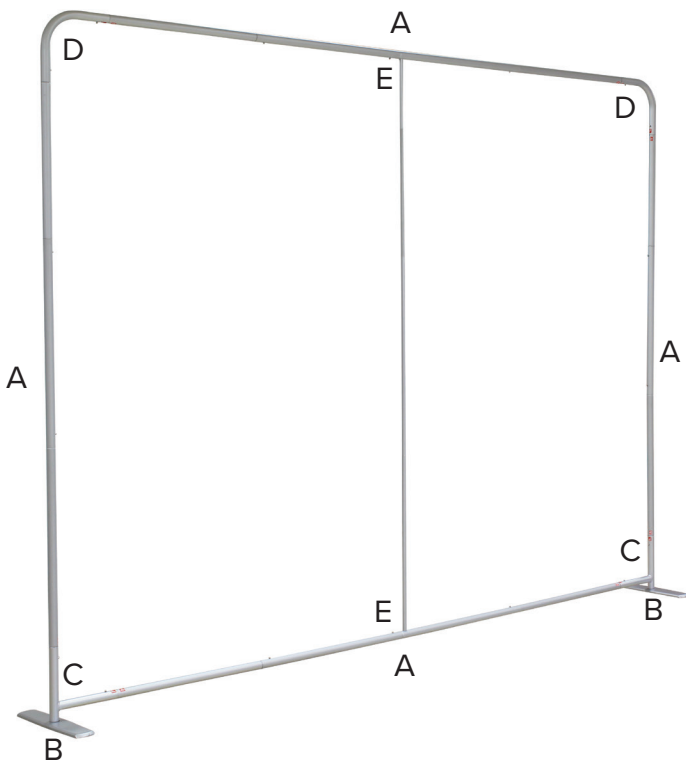

F



D. Top Arch / Horizontal and Vertical Tube

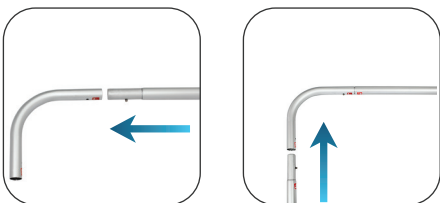

Attach each top corner arch to each side of a horizontal and vertical frame tube. Each end is conveniently marked with a letter/number decal.

E. Middle Support Bar

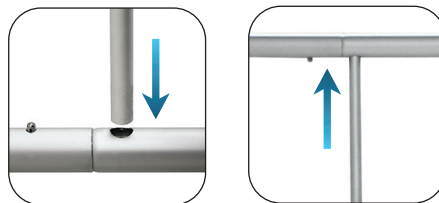

Complete the structure by sliding in the middle support bar, one end at a time.

F. Install Graphic

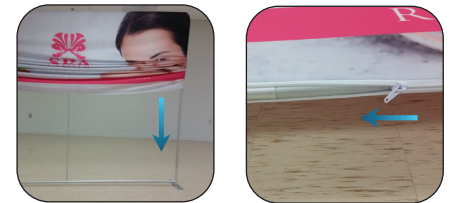

Drape the top of the frame, starting with the open end (bottom) of the graphic. Pull the graphic all the way down and zip the bottom shut to maximize tension.